

**FINAL
CONTAMINATION SCREENING EVALUATION
REPORT**

**PD&E Study
I-75 (S.R. 93) from South of S.R. 56 to North of S.R. 52
Pasco County**

**Work Program Item Segment No. 258736 1
Federal Aid Program No. NH-75-1(91)275**

This project evaluates improvement alternatives for I-75 (S.R. 93) from south of S.R. 56 to north of S.R. 52 in Pasco County, Florida. The approximate length of the project is 19.15 kilometers (11.902 miles).

Prepared for:

**Florida Department of Transportation
District Seven
11201 North McKinley Drive
Tampa, Florida 33612-6403**

Prepared by:

**Post, Buckley, Schuh & Jernigan, Inc.
5300 West Cypress Street
Suite 300
Tampa, Florida 33607**

December 2000

**FINAL
CONTAMINATION SCREENING EVALUATION
REPORT**

**PD&E Study
I-75 (S.R. 93) from South of S.R. 56 to North of S.R. 52
Pasco County**

**Work Program Item Segment No. 258736 1
Federal Aid Program No. NH-75-1(91)275**

This project evaluates improvement alternatives for I-75 (S.R. 93) from south of S.R. 56 to north of S.R. 52 in Pasco County, Florida. The approximate length of the project is 19.15 kilometers (11.902 miles).

Prepared for:

**Florida Department of Transportation
District Seven
11201 North McKinley Drive
Tampa, Florida 33612-6403**

Prepared by:

**Post, Buckley, Schuh & Jernigan, Inc.
5300 West Cypress Street
Suite 300
Tampa, Florida 33607**

December 2000

EXECUTIVE SUMMARY

The Florida Department of Transportation (FDOT) is currently conducting a Project Development and Environment (PD&E) Study on a portion of I-75 (S.R. 93) from south of S.R. 56 to north of S.R. 52 in Pasco County. The roadway is proposed to be improved from the current four lane limited access freeway to a six lane limited access freeway. The existing bridges within the project limits will be widened or replaced.

In accordance with the FDOT policy and the Federal Highway Administration (FHWA) requirements, a contamination screening evaluation has been performed to evaluate potential impacts from contaminated sites to the project. A Contamination Screening Evaluation Report (CSER) has been prepared pursuant to the FHWA's Technical Advisory T 6640.8A and the FDOT's PD&E Manual, Part 2, Chapter 22.

Eleven sites were identified as potential sources of petroleum contamination, and all 11 sites are located at either the S.R. 54 or the S.R. 52 interchanges with I-75. Seven of the 11 sites are located at the S.R. 54/I-75 interchange, which is in Segment B; four of the 11 sites are located at the S.R. 52/I-75 interchange, which is in Segment D. Three sites (one in Segment B and two in Segment D) were assigned a risk rating of "Low", eight sites (six in Segment B and two in Segment D) were assigned a "medium" risk rating, and no sites were assigned a "high" risk rating. The eight sites that were assigned risk ratings of "medium" are recommended for further evaluation in the form of soil and groundwater sampling and testing for the presence of petroleum products.

TABLE OF CONTENTS

<u>Title</u>	<u>Page</u>
EXECUTIVE SUMMARY	i
TABLE OF CONTENTS	ii
LIST OF FIGURES	iii
1.0 INTRODUCTION	1
1.1 Project Need	2
1.2 Existing Facility	2
1.3 Proposed Improvements	3
1.4 Project Segmentation	5
2.0 LAND USES	5
3.0 HYDROLOGIC AND GEOLOGIC FEATURES	6
3.1 Hydrologic Features	6
3.2 Regional Geology	7
3.3 Soils	9
3.4 Surface Water Features	9
3.5 Topography	9
4.0 METHODOLOGY	9
5.0 PROJECT IMPACTS	13
6.0 RECOMMENDATIONS	18
7.0 REFERENCES	19
APPENDIX	

LIST OF FIGURES

<u>Figure Number</u>	<u>Title</u>	<u>Follows Page</u>
1	Project Location Map	1
2	Generalized Existing Land Use Map	6
3	Potential Hazardous Materials Sites	14

1.0 INTRODUCTION

The Florida Department of Transportation (FDOT) is conducting a Project Development and Environment (PD&E) Study for improvement alternatives along I-75 (S.R. 93) from south of S.R. 56 to north of S.R. 52 in Pasco County, Florida. The project location map in Figure 1 illustrates the location and limits of the study.

The objective of the PD&E Study is to provide documented environmental and engineering analyses to assist the FDOT in reaching a decision on the type, location, and conceptual design of the necessary improvements in order to accommodate future traffic demand in a safe and efficient manner. The PD&E Study also satisfies the requirements of the National Environmental Policy Act (NEPA) and the Federal Highway Administration (FHWA) in order to qualify the project for Federal-aid funding of future development phases of the project.

This report documents the need for the improvements and develops and evaluates improvement alternatives as they relate to the transportation facility. Information relating to the engineering and environmental characteristics essential for alternatives and analytical decisions was collected. Once sufficient data were available, design criteria were established and "Build" alternatives were developed. The comparison of these alternatives to the "No Build" alternative was based on a variety of parameters with the goal being to identify the alternative having the least impact, while providing the necessary improvements. The design year for analysis is Year 2020.

In accordance with the FDOT policy and the FHWA requirements, a contamination screening evaluation has been performed to evaluate potential impacts from contaminated sites to the project. A Contamination Screening Evaluation Report (CSER) has been prepared pursuant to the FHWA's Technical Advisory T 6640.8A and the FDOT's PD&E Manual, Part 2, Chapter 22. The objective of the contamination screening evaluation was to provide documented information and analyses to assist FDOT with design and right-of-way (ROW) acquisition.

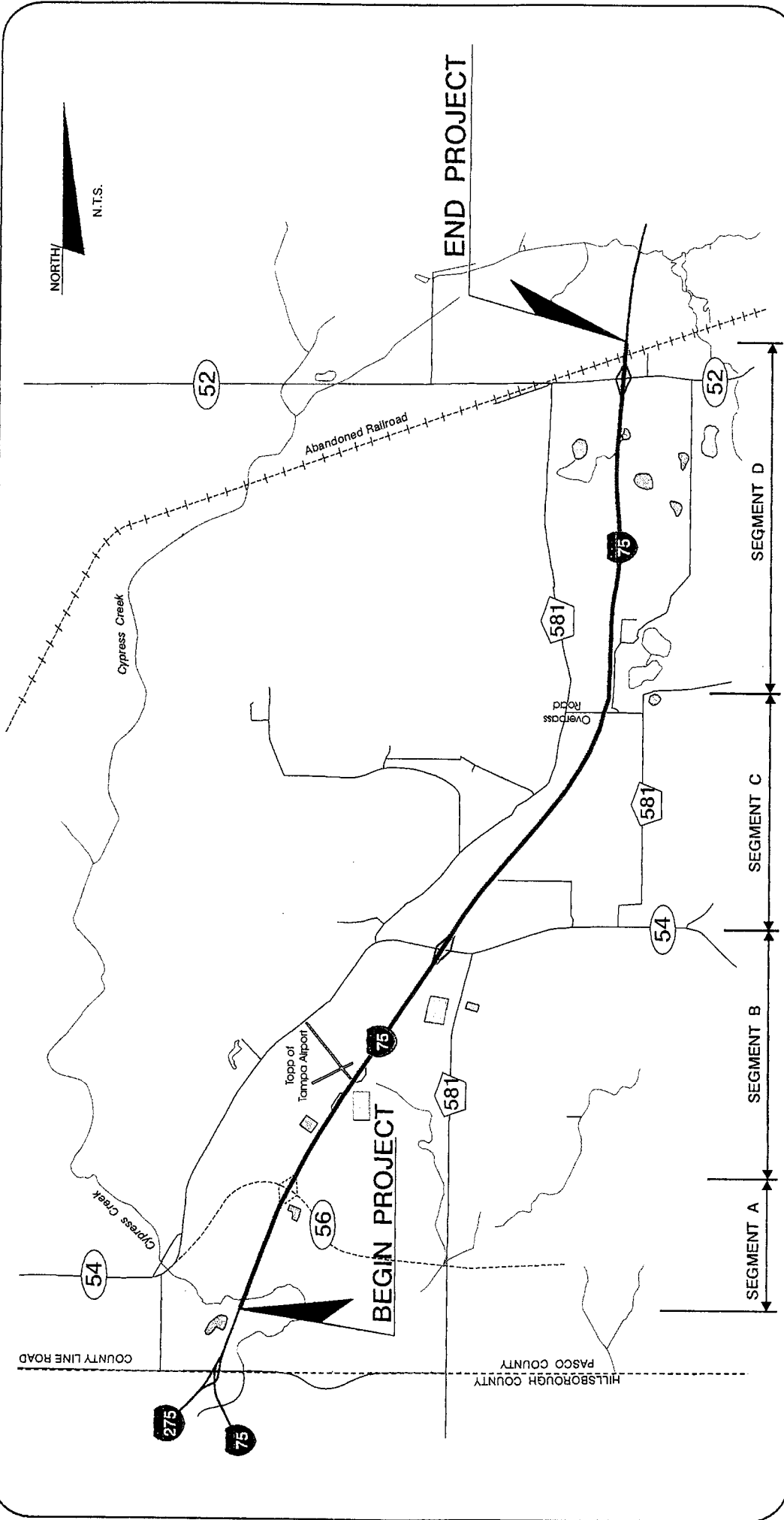

LEGEND

- Project Limits
- River / Water
- Railroad
- State Road Numbers
- County Road Numbers
- Proposed Roadway

FLORIDA DEPARTMENT OF TRANSPORTATION

**I-75 (S.R. 93)
PD&E STUDY**

From South of S.R. 56 to North of S.R. 52
Pasco County, Florida

PROJECT LOCATION MAP

SPN #: 14140-1423
WPI #: 7447619
FAP#: NH-75-(9)275

1.1 Project Need

The I-75 corridor from south of S.R. 56 to north of S.R. 52 is proposed to be improved from a four lane to a six lane freeway. The need for this improvement was established based on the evaluation of the following:

- The existing and expected future quality of traffic operations along the I-75 study corridor under the No-Project alternative;
- Traffic safety statistics for the period between 1991 and 1995;
- Local governments' long-range transportation plans designated need; and
- Social and economic demands.

According to the Pasco County Comprehensive Plan¹ and the Pasco County Metropolitan Planning Organization Adopted 2015 Cost Affordable Transportation Plan², the existing I-75 corridor is functionally classified as a freeway and as a future six lane facility from the Hillsborough County line to S.R. 54. The I-75 corridor is designated as a four lane facility from S.R. 54 through the remainder of Pasco County to the Hernando County line. The improvements under consideration for the I-75 corridor are consistent with the anticipated approval of the Pasco County Metropolitan Planning Organizations 2020 Cost Affordable Transportation Plan³.

1.2 Existing Facility

The I-75 corridor is primarily a north/south facility which, in its entirety, extends from a southern terminus at Miami, Florida, to a northern terminus at Sault Saint Marie, Michigan. The PD&E Study corridor encompasses the portion of I-75 from south of the proposed interchange with S.R. 56 to north of the existing interchange with S.R. 52, in Pasco County, Florida, a distance of approximately 19.15 kilometers (km) [11.902 miles (mi)]. I-75's functional classification is "rural interstate." The facility is also a part of the Federal Aid Interstate System, the Florida Intrastate Highway System (FIHS) and State Highway System.

Please note, the new S.R. 56 interchange is currently under construction and has a scheduled opening year of August 2001. This interchange will therefore be considered an existing condition for the PD&E Study.

Within the study corridor, the existing I-75 mainline roadway primarily features two 3.658 meter (m) (12 feet [ft]) lanes each way, a 19.507 m (64 ft) depressed, grassed median, 3.658 m (12 ft) graded outside shoulders (of which 3.048 m [10 ft] is paved), 2.438 m (8 ft) graded inside shoulders (of which 1.219 m [4 ft] is paved), intermittent open roadside ditches on both sides, and a minimum limited access ROW width of 91.44 m (300 ft). However, the northbound roadway currently features four lanes from south of Cypress Creek to just north of the creek, then tapers successively to three lanes and finally to two lanes near the location of the proposed S.R. 56 northbound exit ramp. The proposed S.R. 56 interchange project will widen only the northbound I-75 roadway in order to maintain the four lanes to the new exit ramp, and thereafter three lanes to the new entrance ramp terminal. In addition, the southbound I-75 roadway currently flares from two lanes to three lanes just north of the bridge over Cypress Creek.

1.3 Proposed Improvements

The preferred alternative mainline typical section features three 3.6 m (12 ft) lanes each way, 3.6 m (12 ft) outside shoulders (of which 3.0 m/10 ft is paved), while retaining the existing 19.507 m (64 ft) depressed median and 3.657 m (12 ft) inside shoulders (of which 3.048 m/10 ft is paved). A reduced border width of 21.567 m (70 ft) is proposed in order to avoid the need for additional ROW acquisition. Since the resultant border width is less than the required 25.0 m (82 ft), a design variation will be required to pursue this typical section.

Providing a loop ramp in the northwest quadrant of the I-75/S.R. 52 interchange would eliminate the conflict of the westbound to southbound left-turn movement with the eastbound through movement. The loop ramp would also eliminate the conflict of the westbound to southbound left-turn movement with the eastbound to southbound right-turn movement, as

these movements merge together on the southbound entrance ramp to I-75. The implementation of the loop ramp would reduce the signal operation from the existing three-phase to a two-phase signal operation, thus increasing the capacity of the intersection on the west side of the interchange. The loop ramp would ensure that the interchange could accommodate heavier traffic volumes while maintaining an acceptable level of service (LOS). Significantly higher traffic volumes, especially for the westbound to southbound movement, could be accommodated at the interchange. This would reduce queuing on the west side of the interchange and prevent potential queues from extending into the east side of the interchange.

The Interchange Modification Report (IMR) was reviewed and preliminarily accepted by FHWA. The recommended loop ramp alternative was selected as the most cost effective alternative which meets the objectives of the IMR. This alternative accommodates future travel demand, maintains an acceptable LOS, and by eliminating the need for an additional interstate access location, does not degrade the operations of the interstate mainline. Queuing on the northbound exit ramp will also be reduced, thus improving safety along the interstate mainline. This loop ramp alternative also provides for heavy vehicles safe and easy access to adjacent land uses and to the southbound interstate. The recommended loop ramp alternative requires the least amount of ROW, has the least potential of affecting the surrounding environment, and improves traffic operations for local cross streets and cross street intersections.

Increasing capacity at the S.R. 52 interchange is necessary because it will address the anticipated future development in the north and eastern areas of Pasco County. Future development in the remaining portions of Pasco county is limited due to the presence of well fields throughout the remaining areas of Pasco County.

1.4 Project Segmentation

Project segmentation is used in this type of study in order to effectively assess and compare the impacts of each alternative in different geographical areas within the project. After considering the interchange locations and type and age of existing structures along I-75 the project was divided into four study segments as follows:

- Segment A: South of Cypress Creek to north of the proposed S.R. 56 interchange.
- Segment B: North of the proposed S.R. 56 interchange to north of the S.R. 54 interchange.
- Segment C: North of the S.R. 54 interchange to north of Overpass Road.
- Segment D: North of Overpass Road to north of the S.R. 52 interchange.

The I-75 corridor is primarily a north/south facility which, in its entirety, extends from a southern terminus at Miami, Florida to a northern terminus at Sault Saint Marie, Michigan. The PD&E Study corridor encompasses the portion of I-75 from south of the proposed interchange with S.R. 56 to north of the existing interchange with S.R. 52, in Pasco County, Florida, a distance of approximately 19.15 km (11.902 mi). I-75's functional classification is "rural interstate." The facility is also a part of the Federal Aid Interstate System, the FHHS and State Highway System.

Please note, the new S.R. 56 interchange is currently under construction and has a scheduled opening year of August 2001. This interchange will therefore be considered an existing condition for the PD&E Study.

2.0 LAND USES

Land use within close proximity of the project limits is predominately undeveloped. Commercial development exists at the southern and northern limits of the project where S.R. 54 and S.R. 52 intersect I-75. South of the S.R. 54 intersection are rest stops on the west and

east sides of I-75. South of S.R. 54 on the west side of I-75 is a small, private airport and a large single family and multi-family residential development. Along I-75, between S.R. 54 and S.R. 52 are scattered single family homes and some single family developments. South of S.R. 54 on the east side of I-75 is the small Wesley Chapel wastewater treatment plant (WWTP) and north of S.R. 54 on the east side of I-75 is the Wesley Center WWTP owned by Pasco County. The undeveloped land along the corridor is composed of wetlands, upland forest, rangeland, and agricultural land.

Historical aerial photographs were reviewed for the project corridor and surrounding lands. Lands throughout the corridor were either undeveloped or utilized as farmlands with few residential developments sparsely scattered throughout the area. More intense development did not begin in this area of Pasco County until the completion of I-75. Figure 2 illustrates the generalized existing land use along the I-75 corridor.

3.0 HYDROLOGIC AND GEOLOGIC FEATURES

3.1 Hydrologic Features

Pasco County is generally underlain by a surficial aquifer system and the deeper Floridan aquifer system. The surficial aquifer system is defined as a permeable hydrologic unit contiguous with the land surface. Quarternary Undifferentiated Pliocene-Pleistocene surficial sediments comprise the surficial aquifer system. The lower limit of the surficial aquifer system coincides with the top of the laterally extensive and vertically persistent beds of lower permeability. The surficial aquifer system sediments are often characterized by quartzitic sands, ranging from: fine to coarse grained; nonindurated to poorly indurated; and nonclayey to slightly clayey.









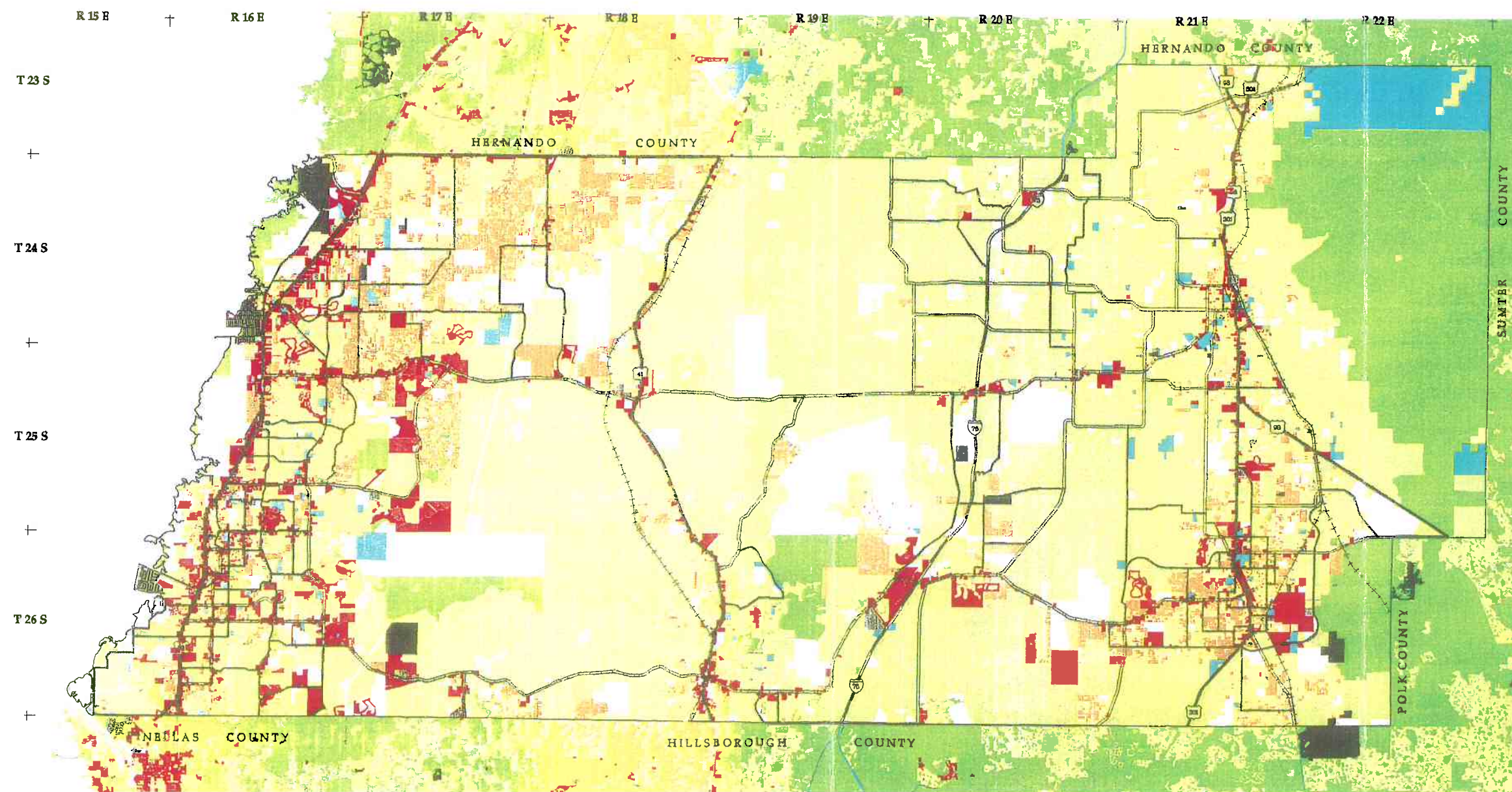

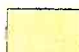
The Floridan aquifer system is typically found at mean sea level (msl) in the vicinity of the project area. The deeper Floridan aquifer system flows among the limestones of Eocene Ocala Group and the Eocene Avon Limestone Formations. The aquifer extends from approximately 1,000 to 1,200-ft below msl. The Floridan aquifer is recharged through



**THE COMPREHENSIVE PLAN
OF UNINCORPORATED
PASCO COUNTY**

**MAP # 2 - 10
GENERALIZED EXISTING
LAND USE
1995**

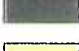

-  VACANT
-  SINGLE FAMILY
-  MOBILE HOME
-  MULTI FAMILY
-  COMMERCIAL
-  OFFICE
-  INDUSTRIAL
-  PUBLIC / SEMI PUBLIC
-  MINING
-  GENERAL AGRICULTURE
-  OPEN SPACE / WETLANDS

SOURCES:
ADJACENT LAND USES - SWFWMD - 1993
PASCO COUNTY PROPERTY APPRAISER - 1995



FIGURE 2

precipitation in areas where the aquifer is at or near land surface. Recharge of the aquifer system in the project area is very low to moderate.

3.2 Regional Geology

Pasco County is situated on the Gulf Coastal Lowlands geomorphological province of Florida. This area is underlain mostly by marine carbonate and siliclastic sediments. The sequence of rock units in the project area is as follows, from oldest to youngest: the Cedar Keys Formation (Tertiary System - Paleocene Series); the Oldsmar Formation, the Avon Park Formation, and the Ocala Limestone (Tertiary System - Eocene Series); the Suwannee Limestone (Tertiary System - Oligocene Series); the Hawthorn Formation (Tertiary System - Miocene Series); and the Undifferentiated Pleistocene - Holocene Sediments (Quaternary System - Pliocene-Pleistocene Series).

The Tertiary System geology in the study area is generally composed of four series. These series and their respective Lithostratigraphic Units are characterized, from oldest to youngest, below.

Paleocene Series

The Paleocene Series siliclastic sediments form the sub-Floridan confining unit in the area. These sediments are composed of low permeability, fine sands, and impure limestone. The occurrence of carbonate sediments (dolostone) are characteristically seen interbedded with evaporite minerals throughout this section. The Cedar Keys Formation is the Lithostratigraphic Unit for this Series. The Cedar Keys Formation is identified as coarsely crystalline, porous dolostone and evaporites (gypsum and anhydrite).

Eocene Series

The Eocene Series forms a large portion of the Floridan aquifer system. This series is composed primarily of carbonate sediments. A carbonate-forming environment evolved over what had predominately been a siliclastic depositional environment during the Paleocene Series period. Lithostratigraphic Units of the Eocene Series are the Oldsmar Formation, the

Avon Park Formation, and the Ocala Limestone. The Oldsmar Formation is an interbedded limestone with vuggy dolostone. Pore-filling gypsum and thin beds of anhydrite occur in some places throughout the Formation often forming the base of the Floridan aquifer system. The Avon Park Formation is a fossiliferous limestone interbedded with vuggy dolostone. Evaporites may be present as vug fillings in the dolostone. The Ocala Limestone is subdivided into lower and upper portions. The lower portion is characterized as a granular limestone (grainstone to packstone). The upper portion is identified as a variable muddy (carbonate) granular limestone (packstone to wackestone with very limited grainstone). The upper portion is often soft and friable with numerous large foraminifera. Chert is also a common component.

Oligocene Series

The Oligocene Series is composed of the carbonate sediments of the Suwannee Limestone. The Suwannee Limestone is variable vuggy and muddy. This limestone is identified as grainstone to packstone.

Miocene Series

The Miocene Series is a mixed deposition of carbonate and siliclastic sediments. A distinct depositional environmental change occurred during this period. This mixture of carbonate and siliclastic sediments produced an occurrence of abundant phosphate, palygorskite, opaline cherts, and other uncommon minerals. An abundance of dolomite also occurred within the Hawthorn Formation. The Lithostratigraphic Unit of the Miocene Series is the Hawthorn Formation. The Hawthorn Formation is comprised of a complex series of phosphate bearing limestone.

The Quarternary System in the study area is typically composed of only one series (Pliocene-Pleistocene Series). The sediments of the Pliocene-Pleistocene Series range from nonfossiliferous, clean sands to very fossiliferous sandy clays and carbonates. These unconsolidated sediments overlie the Hawthorn Formation and make up the surficial water table aquifer in the area.

3.3 Soils

Soils throughout the project corridor have been categorized by the United States Department of Agriculture (Soil Survey of Pasco County, Florida⁴). The soils found within the study and surrounding areas include four general soil map units. These units are: Tavares-Adamsville-Narcossee; Tavares-Sparr-Adamsville; Pomona-EauGallie-Sellers; and Chobee.

3.4 Surface Water Features

There are no major water bodies within close vicinity of the study area. There are unnamed ponds (both manmade and natural) and wetlands found throughout the project corridor. Cypress Creek is located at the southern end of the project corridor and flows in a westerly direction.

3.5 Topography

The project corridor is nearly level with elevations ranging from approximately 90 ft to 100 ft above msl throughout the northern portion of the corridor. Elevations range from approximately 50 ft to 85 ft msl across the southern section of the corridor. A gradual slope is evident throughout the project corridor, with slightly higher elevations found along the center of the corridor and slightly lower elevations found at the southern end.

4.0 METHODOLOGY

The purpose of the contamination screening was to identify petroleum and non-petroleum contamination sites within the project corridor that, through past or present use, could potentially impact the proposed project.

Since certain chemical compounds are known to persist in the environment for years after their introduction, the corridor's development history was reviewed. Vacant, cleared lands and adjacent properties were also included in the contamination screening process. Adjacent

properties are those which are not contiguous to the FDOT proposed ROW. Lands were viewed from a historical perspective to determine whether or not the property had been engaged in activities relating to petroleum pollutants or non-petroleum pollutants. Primary among the data sources were the R.L. Polk City Directories and historical aerial photographs. The aerial photographs provided visual evidence of past land uses for both the subject property and the surrounding areas to identify properties along the ROW which could be contaminated as a result of a previous land use. This information was combined with the findings of the historical occupant searches to aid in the evaluation of previous land uses.

A regulatory review of federal and state environmental records was conducted on June 25, 1996 and August 20, 1997. The records reviewed included information compiled by the United States Environmental Protection Agency (USEPA), the Florida Department of Environmental Protection (FDEP), and the Pasco County Department of Health. Files of potentially contaminated sites were reviewed at both FDEP and the Pasco County Department of Health.

A computerized database search of federal and state environmental regulatory agencies was obtained from Environmental Data Management, Inc. (EDM) of Largo, Florida⁵. A copy of the baseline data search is contained in the Appendix. The Federal databases that were searched are:

- National Priorities List (NPL): This database contains a listing of facilities and/or locations where environmental contamination has been confirmed. Sites are prioritized for remedial action by the USEPA. No sites were identified within a one-mile radius of the corridor.
- Comprehensive Environmental Response, Compensation and Liability Index System (CERCLIS): The CERCLIS list contains facilities and/or locations that the USEPA or state environmental agency is investigating to determine if an existing or threatened release of hazardous substances is present. No CERCLIS sites were identified within a one-mile radius of the corridor.

- Emergency Response Notification System (ERNS): ERNS is a national computer database system that is used to store information on the release of hazardous substances into the environment. The ERNS report system contains preliminary information on specific releases, including the spill location, the substance released, and the responsible party.
- Resource Conservation and Recovery Act Index System List (RCRIS): The RCRIS list identifies those facilities or locations that have notified the USEPA of their activities relative to the handling of hazardous wastes. They appear as transporters, storers and/or disposers of hazardous wastes (TSDs) or permitted generators of hazardous wastes (non-TSDs). The appearance of a site on this list does not necessarily indicate environmental problems on the site, but rather that the site is (or was) engaged in hazardous waste handling activities and, therefore, may have the potential to cause environmental degradation if hazardous wastes have been mishandled or otherwise released in an uncontrolled manner.
- Facility Index Data System (FINDS): This list identifies facilities and/or locations that are subject to regulation under certain USEPA programs, due to operations conducted at these sites. The appearance of a site on this list does not necessarily indicate environmental problems on the site, but rather that the site conducts operations that may have a potential to cause environmental degradation if hazardous compounds are released in an uncontrolled manner.
- Toxic Release Inventory (TRI): This database contains information on the annual estimated releases of toxic chemicals to the environment. Data includes the maximum amount stored on site, the estimated quantity emitted to the air, discharged into bodies of water, injected underground or released to land, methods used in waste treatment and their efficiency, and data on the transfer of chemicals off-site. The presence of a facility on this list does not necessarily indicate environmental problems. No sites were identified within a one-mile radius of the corridor.

The State databases that were searched are:

- State Funded Action Sites (SFAS): The SFAS contains locations that have been identified by the FDEP as having known environmental contamination and are currently part of the state-funded cleanup action. No sites were identified within a one-mile radius of the corridor.
- Solid Waste Facilities (SLDWST): This list identifies locations that have been permitted to conduct solid waste landfilling activities or other waste handling activities such as transfer stations. Sites handling bio-hazardous wastes are included on the SLDWST.
- Stationary Tank Inventory System (STIS): This list identifies sites that have registered above-ground and underground petroleum storage tanks. It also includes those sites that have registered for participation in the FDEP Dry-cleaning Solvent Cleanup Program.
- Petroleum Contamination Tracking System (PCT): Appearance on this report indicates that a discharge of petroleum has been reported.
- Hazardous Waste Quick Look Report (HWQL) This database identifies facilities that have notified the FDEP of their activities with the handling of hazardous waste. The presence of sites on this list does not necessarily indicate environmental problems unless they were handled improperly. The following sites were identified through the HWQL.

A corridor visit was conducted on August 19, 1997, and each site with contamination potential was inspected and evaluated for on-site conditions. This information was factored into the overall corridor evaluation.

The contamination rating system utilized is divided into four degrees of risk: No, Low, Medium, and High. The sites that were rated as "No" are not discussed in this report. This system expresses the degree of concern for potential contamination problems within the corridor. All of the components of the corridor evaluation are used to develop the risk rating given to each individual site.

5.0 PROJECT IMPACTS

The first phase of the contamination evaluation of properties along the project corridor is a data collection effort, which includes a review of regulatory agency information, business directories, and historical aerial photographs, and an initial site inspection. Because of the rural nature of the corridor and the recent development activity, the business directories proved to be of minimal assistance in evaluating the historic aspects of the corridor. The second and final phase of the evaluation is more in-depth, on-site surveys and research.

On August 19, 1997, a trained environmental professional conducted a physical inspection of each property around the project corridor. Twenty-two sites were reviewed during the contamination screening evaluation. Systematic inspections of each site included looking for apparent changes to the ground surface, ground staining, standing liquids, odors, ventilation pipes, fill caps, drums, pump islands, containers, and other signs of potential contamination. Interviews were conducted with persons knowledgeable about the property and, when possible, its history.

Beginning at the southern end of the corridor and moving north, the majority of the surrounding properties are undeveloped. Wesley Chapel WWTP lies approximately 100 m (328.08 ft) east of the corridor at the beginning of Segment B. After a cursory review of the sewage treatment plant, there appears to be limited potential for petroleum or hazardous waste-related contamination. This facility was ranked as a low risk factor.

Continuing north, the adjacent properties remain undeveloped up to the FDOT rest areas which are located in both the north and southbound lanes. The first concentration of

development occurs at the S.R. 54/I-75 interchange. Six active fuel stations are located within 175 m (574.15 ft) of the corridor. Other development near the intersection includes restaurants and a commercial shopping plaza.

Agricultural, scattered residential, and undeveloped properties comprise the adjacent parcels north of S.R. 54. A large sewage treatment facility is located on the east side of the corridor in Segment C. No petroleum or hazardous waste related concerns were visible at the plant during the reconnaissance. An associated spray field is located across I-75. After a cursory review of the sewage treatment plant, there appears to be limited potential for petroleum or hazardous waste-related contamination. This site was ranked as a low risk factor.

Agricultural, residential, and undeveloped lands lie between S.R. 54 and S.R. 52. Pasco Lakes, Inc. operates an active construction and demolition debris landfill (Permit #S051-254164) on Old Pasco Road, midway between S.R. 54 and S.R. 52. This unlined landfill has been active since October 1990. No significant concerns were noted in the regulatory files regarding this site. Employees at the facility monitor dumping activities to assure that no other wastes are accepted. There are no monitoring wells installed at the facility; therefore, if hazardous waste or petroleum compounds were inadvertently disposed of at this site, there is the potential for groundwater contamination. This site was ranked as a low risk factor.

The next concentration of development is located at the S.R. 52 interchange. Four active retail petroleum facilities are situated within 125 m (410.10 ft) of the corridor.

Eleven sites were determined to be potential sources of petroleum contamination; no sites were determined to be potential sources of hazardous waste contamination. Of the 11 sites, three sites were assigned a risk rating of "low", eight sites were assigned a "medium" risk rating, and no sites were assigned a "high" risk rating. Figure 3 illustrates the approximate location of these sites. The following discussion of the 11 sites lists the name, address, facility identification number, type of contamination concern, and contamination evaluation risk rating for each suspect site.

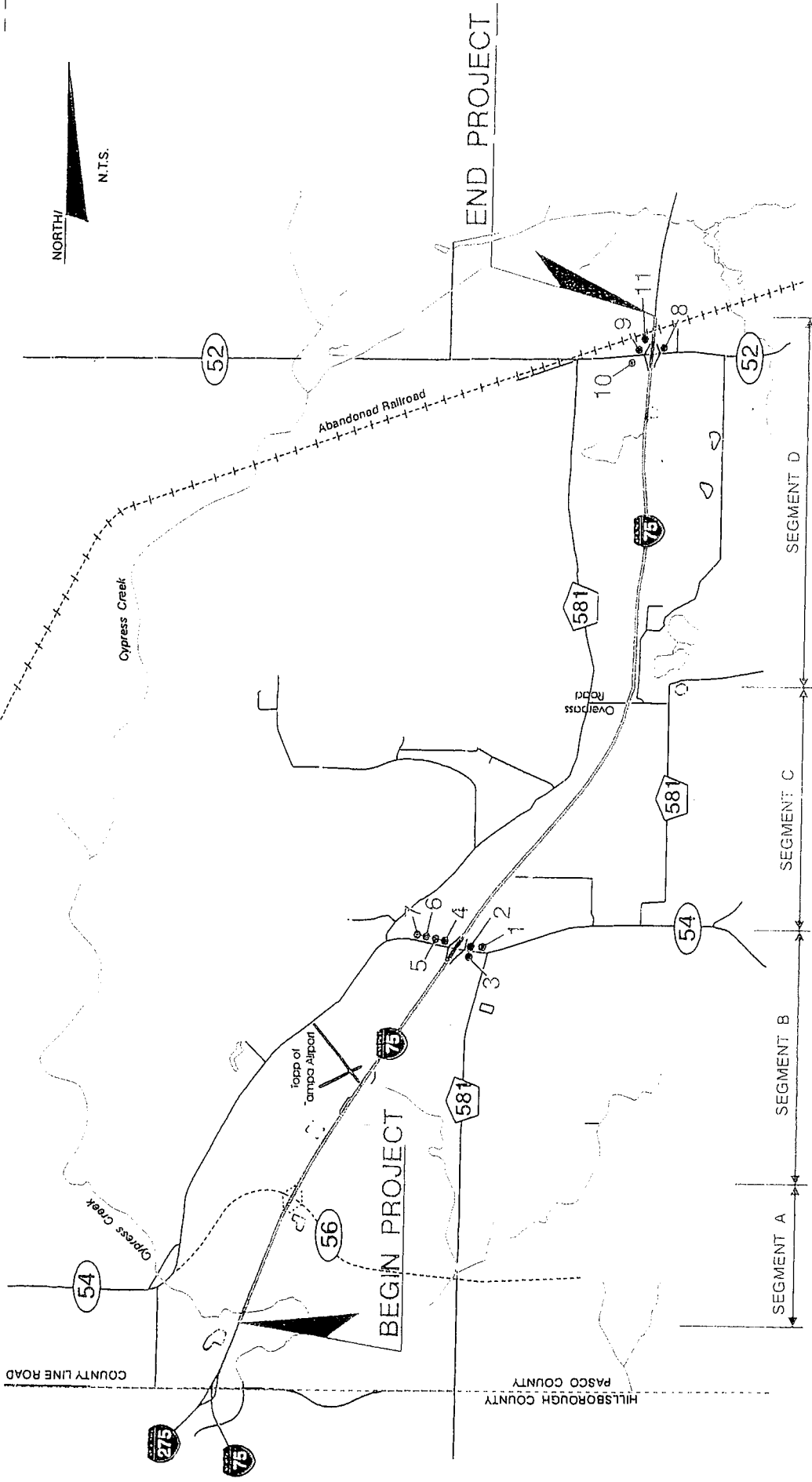

FLORIDA DEPARTMENT OF TRANSPORTATION

I-75 (S.R. 93)

PO&E STUDY

From South of S.R. 56 to North of S.R. 52
Pasco County, Florida

POTENTIAL HAZARDOUS MATERIAL SITES

SPN #: 14140-1423
WPI #: 7147619
FAPI: NH-75-1(91)275

FIGURE 3

LEGEND

- Project Limits
- ~ River / Water
- ++++ Railroad
- (54) State Road Numbers
- (581) County Road Numbers
- - - Proposed Roadway
- Potential Hazardous Material Sites

Site No. 1, Racetrac #407, 28053 S.R. 54, Facility ID# 519100181

This site is located at the northeast quadrant of the I-75/S.R. 54 interchange. Two 12,000-gallon underground petroleum storage tanks are registered at this facility. The tanks were installed in 1990. Risk rating "low."

Site No. 2, Oakley Groves, Inc, S.R. 54 and I-75, Facility I.D. #518515016

This site is located at the northeast quadrant of the I-75/S.R. 54 interchange. Four 10,000-gallon underground petroleum storage tanks are registered as no longer in service since June 1991. Soil and groundwater contamination were identified through an environmental assessment performed by Florida Groundwater Services in 1991. The groundwater flow is to the southeast. High Tech Environmental Services initiated cleanup of the site and over 489,250 gallons of groundwater have been treated using two production wells pumping to two 55-gallon granulated activated carbon vessels. Groundwater contamination levels are within cleanup target levels throughout the site except in one well. One production well continues to operate in order to complete the remediation. Risk rating "medium."

Site No. 3, Gas Kwick #49 (Texaco) former Exxon, 28014 C.R. 54, Facility I.D. #519046575

This site is located at the southeast quadrant of the I-75/S.R. 54 interchange. Three 10,000-gallon, underground petroleum storage tanks are registered at this site. The tanks were installed in May 1990. This site was approved for cleanup activities under FDEP's revised tanks program. A contamination assessment performed by Tower Environmental was approved by the FDEP in September 1994. No other information was available through the FDEP District Office or Pasco County Health Department. Risk rating "medium."

Site No. 4, Tillack and Sons, Inc.(Chevron), 27829 W. S.R. 54, Facility I.D. #518515078

Tillack and Sons is located at the northwest quadrant of the I-75/S.R. 54 interchange. Three 10,000-gallon underground petroleum fuel tanks were installed between the years 1979 and 1983 and are registered as in use. One 1,000-gallon underground waste oil tank was reportedly taken out of service in 1991. The FDEP approved a Contamination Assessment Report (CAR) performed by EDER Associates in April 1995. The report indicated that

contamination was limited to the site. Groundwater flow was measured to flow toward the south-southwest. Approximately 400 cubic yards of excessively-contaminated soil were removed from the property as part of an initial remedial action. No other information was available through FDEP District Office or Pasco County Health Department files. Risk rating "medium."

Site No. 5, Masters Economy Inn, 27807 S.R. 54, Facility I.D. #519201573

This site is located at the northwest quadrant of the I-75/S.R. 54 interchange. The STI database does not give specific information regarding this site. An underground petroleum storage tank was uncovered during construction of a canopy in the motel driveway. The site was approved for cleanup under the revised FDEP tanks program. Risk rating "medium."

Site No. 6, Amoco #10710,15016 W. Highway 54, Facility I.D.#518520035

This site is located at the northwest quadrant of the I-75/S.R.54 interchange. Four 10,000-gallon underground petroleum storage tanks, installed in June 1984, are registered for this facility. A CAR prepared by Geraghty and Miller was approved by the FDEP in October 1993. Groundwater flow direction was determined to be in a southeasterly direction. Groundwater contamination was limited to the site. The site was approved for cleanup under the revised FDEP tanks program. No other information was available through FDEP District Office or Pasco County Health Department files. Risk rating "medium."

Site No. 7, Circle K #7475, Highway 54 and I-75, FLD#984254748, Facility I.D. #518520488

This site is located at the northwest quadrant of the I-75/S.R. 54 interchange. Four 10,000-gallon underground petroleum storage tanks, installed in July 1985, are registered with the FDEP for this facility. ATEC prepared a CAR in 1995. The groundwater flow direction at the time of the CAR was to the southwest. No other information was available through FDEP District Office or Pasco County Health Department files. Risk rating "medium."

Site No. 8, Chevron #47132, I-75 and S.R. 52 I-75 and S.R. 52, FLD#051565117, Facility I.D. #518515028

This facility was formerly located at the northeast quadrant of the I-75/S.R. 52 interchange. Six underground petroleum storage tanks ranging in size from 550 to 10,000 gallons are registered for this facility. The FDEP lists this site as a closed facility. Three 10,000-gallon underground petroleum storage tanks were excavated and removed from this inactive station in 1991. The Tank Closure Assessment was performed by Delta Environmental Consultants on March 3, 1991. No contamination was found during the assessment. Risk rating "low."

Site No. 9, Mobil #02-DHQ, I-75 and S.R. 52 West, Facility I.D. #518519953

This former facility was located at the northwest quadrant of the I-75/S.R. 52 interchange. Eight underground petroleum storage tanks ranging in size from 1,000 gallons to 10,000 gallons were removed from service between 1985 and 1991. Five underground petroleum storage tanks were removed from the property in 1991. Approximately 2,200 cubic yards of excessively contaminated soil were removed from the property as part of the initial remedial action. The CAR was completed by Missimer and Associates and approved by the FDEP in January 1992. Groundwater flow was identified in the CAR as moving towards the south-southeast. The site is eligible for reimbursement under the revised tanks program at FDEP. Risk rating "medium."

Site No. 10, Roberts and Associates, 8611 S.R. 52, Facility I.D. #518520041, FLD#051565117

This facility has been closed since late 1990. Ten underground petroleum storage tanks ranging in size from 1,000 to 20,000 gallons were removed from service in 1992. FDEP determined that this site is not eligible for cleanup under the revised tanks program. No additional information was available at the FDEP District Office or Pasco County Health Department. Risk rating "medium."

Site No. 11, Pasco Fuel and Food Shoppe (Stuckeys), I-75 and S.R. 52, Facility I.D. #518630460

This site is located at the northwest quadrant of the I-75/S.R. 52 interchange. Four underground petroleum storage tanks ranging in size from 6,000 to 10,000 gallons were installed between 1972 and 1987. Groundwater contamination was discovered at this site in 1988. The CAR prepared by Gurr Omega in 1995 recommended a Monitoring Only Plan due to the limited extent of contamination. The CAR was approved by FDEP in April 1996. Risk rating "low."

6.0 RECOMMENDATIONS

This CSER represents an appropriate inquiry and investigation of the sites within the project limits to determine the existence of contamination based on: apparent possible on-site sources of contamination; apparent possible neighboring sources of contamination; regulatory data obtained from federal, state, and local agencies; and review of available historic aerial photography.

Through the contamination screening evaluation, 11 potentially contaminated sites were identified. All 11 sites have the potential for petroleum contamination. Three sites were assigned a risk rating of "low", eight sites were assigned a "medium" risk rating, and no sites were assigned a "high" risk rating. The eight sites that were assigned risk ratings of "medium" are recommended for further evaluation in the form of soil and groundwater sampling and testing.

It should be noted that all but the most extensive investigation could fail to identify a buried, covered-over or localized subsurface event of toxic or hazardous waste or uncontrolled dumping within the study area that is not visible at the ground surface. This report is also limited to the information available at the time the field inspections and agency file searches were performed.

7.0 REFERENCES

1. Pasco County Comprehensive Plan; Pasco County Planning Department; Pasco, Florida; December 1995.
2. Pasco County Metropolitan Planning Organization Adopted 2015 Cost Affordable Transportation Plan; Pasco County Metropolitan Planning Organization; New Port Richey, Florida; December 18, 1995.
3. Pasco County Metropolitan Planning Organizations 2020 Cost Affordable Transportation Plan; Pasco County Metropolitan Planning Organization; New Port Richey, Florida.
4. United States Department of Agriculture, 1989. Soil Survey of Pasco County, Florida.
5. Environmental Data Management, Inc. June 25, 1996. EDM Report. Largo, Florida.

APPENDIX

Environmental Data Management Report

ENVIRONMENTAL DATA REPORT

Approx. 12 x 0.25 Mile Corridor
I-75 Corridor
From I-275/75 Junction to SR 52
Pasco County, Florida
Client Project #99-027.82

Prepared For:

POST BUCKLEY SCHUH & JERNIGAN INC
5300 West Cypress Street, Suite 300
Tampa, FL 33607

Prepared By:

ENVIRONMENTAL DATA MANAGEMENT, INC.
12360 66th Street North
Largo, Florida 34643

25 JUNE 1996





25 June 1996

Bill Bozeman
POST BUCKLEY SCHUH & JERNIGAN INC
5300 West Cypress Street, Suite 300
Tampa, FL 33607

Subject: **Environmental Data Report--EDM Job No: 7523**

Dear Mr. Bozeman:

Thank you for your interest in our Environmental Data Report. Enclosed please find the information you requested for the following location:

**Approx. 12 x 0.25 Mile Corridor
I-75 Corridor
From I-275/75 Junction to SR 52
Pasco County, Florida
Client Project #99-027.82**

The following lists were queried to determine whether sites listed in the USEPA or FDEP environmental records that we have compiled in our database¹ were present within your specified search criteria:

USEPA INFORMATION

NATIONAL PRIORITIES LIST (NPL)
COMPREHENSIVE ENVIRONMENTAL RESPONSE, COMPENSATION AND
LIABILITY INFORMATION SYSTEM LIST (CERCLIS)
EMERGENCY RESPONSE NOTIFICATION SYSTEM LIST (ERNS)
RCRA ADMINISTRATIVE ACTION TRACKING SYSTEM LIST (RAATS)
RESOURCE CONSERVATION AND RECOVERY INFORMATION SYSTEM (RCRIS)
HAZARDOUS WASTE DATA MANAGEMENT SYSTEM LIST (HWDMS)
FACILITY INDEX DATA SYSTEM LIST (FINDS)
TOXIC RELEASE INVENTORY SYSTEM LIST (TRIS)

FDEP INFORMATION

FLORIDA STATE FUNDED ACTION SITES LIST (SFAS)
FLORIDA SITES LIST (SITES)
SOLID WASTE FACILITIES LIST (SLDWST)
PETROLEUM CONTAMINATION TRACKING SYSTEM REPORT (PCTS)
STATIONARY TANKS INVENTORY SYSTEM LIST (TANKS)
HAZARDOUS WASTE QUICK LOOK REPORT (HWQL)

¹ Regulatory list updates are exhibited at the bottom of each database explanation page, found in the main body of the report. This date reflects the date on which the source agency compiled the information for EDM.

In order to query our database for the listings that lie within your specified study area, EDM utilized the information supplied by you, in conjunction with our computerized map data, which is based upon U.S. Census Bureau TIGER/Line files. For your convenience, all sites identified within your research area have been displayed on a map and compiled into a Master List, found at the beginning of our report.

Please note that because our computerized maps are based upon U.S. Census Bureau files, absolute precision in facility placement is not possible. The map scale and site locations shown on the map are therefore approximate, and are provided for general orientation purposes only. However, actual site locations will seldom be found more than several hundred feet from the reported location. Due to this potential variation, we actually query a radius slightly larger than that requested (typically 0.05 miles more). Additionally, we have indicated a secondary series of facilities and Master Table as Appendix A, which provides locations found slightly outside of the requested research area (typically 0.1 - 0.2 miles).

The locations identified on our maps represent specific address points along a roadway. However, a large parcel may have a street address located hundreds (if not thousands) of feet away from its property boundary. Appendix A is therefore useful in identifying large facilities with street addresses that fall outside of the research area, but with property boundaries which may extend well into the research area. Finally, you may simply be interested in a facility which occurs slightly outside of the study area, particularly if extensive contamination has been reported. If you are interested in obtaining detailed information concerning any location listed in Appendix A, simply contact us and we'll rush you the complete report on the facility, at no additional charge.

We have also provided an Appendix B, which includes a third Master Table for all facilities identified within a two mile radius which fall upon the NPL, CERCLIS, ERNS, SITES, SFAS, and SOLID WASTE FACILITIES lists. Facilities referenced on these lists often create a higher level of environmental concern, and many of our clients appreciate having this additional information, either for inclusion in their report or simply to become more familiar with the sites of potential regional concern. If you would like specific information on any of the sites appearing in Appendix B, please contact us and we will be happy to supply you with this information at no additional cost.

Finally, Appendix C is a listing of facilities in the region which were not mapped, typically due to insufficient or incorrect address information. This section is broken into three sub-groups:

1) Those non-mapped locations with zipcode information equal to the subject property, along with any other zipcodes you wish us to include (supplied by you on our order form). We add to this list any zipcodes listed in the records of all facilities identified within your research area, and perhaps pick up some historical zipcodes you may not have been aware of.

2) Those non-mapped locations with no zipcode information, but reportedly located in the city in which your site is located (or any adjacent cities you wish us to query). As above, we will query all records identified within your research area, and add any additional cities to the list, if necessary.

3) Those non-mapped sites with no zipcode or city information, but reportedly located in the county in which your site is located (or an additional adjacent county, if your site is very close to the county boundary).

Our report is a listing of facilities and locations that have been, or are presently involved in activities related to the handling of potentially hazardous materials. Based upon the type of activities conducted on these sites, the potential for environmental degradation to exist on that site and proximal sites may be present. Once identified as a potential risk, each facility or site listed can be further researched by visiting or communicating with local, State or Federal authorities. Without information such as that provided by our report, facilities known to be an environmental hazard or of potential concern to your study location may go undetected in your evaluation.

We at EDM take great pride in our work, and continually strive to provide you with the most thorough and comprehensive service available. However, our ultimate goal is to make your job a little easier. We are always searching for ways to improve upon our service, so don't hesitate to provide us with your suggestions!

Should you have any questions regarding this report or our service, please do not hesitate to contact us. We appreciate the opportunity to be of service to you and look forward to working with you in the future.

Sincerely,

ENVIRONMENTAL DATA MANAGEMENT, INC.

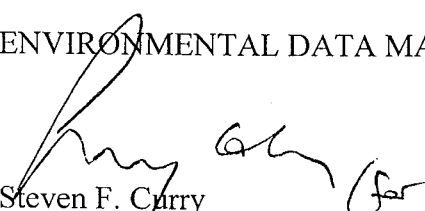
Steven F. Curry
Vice President



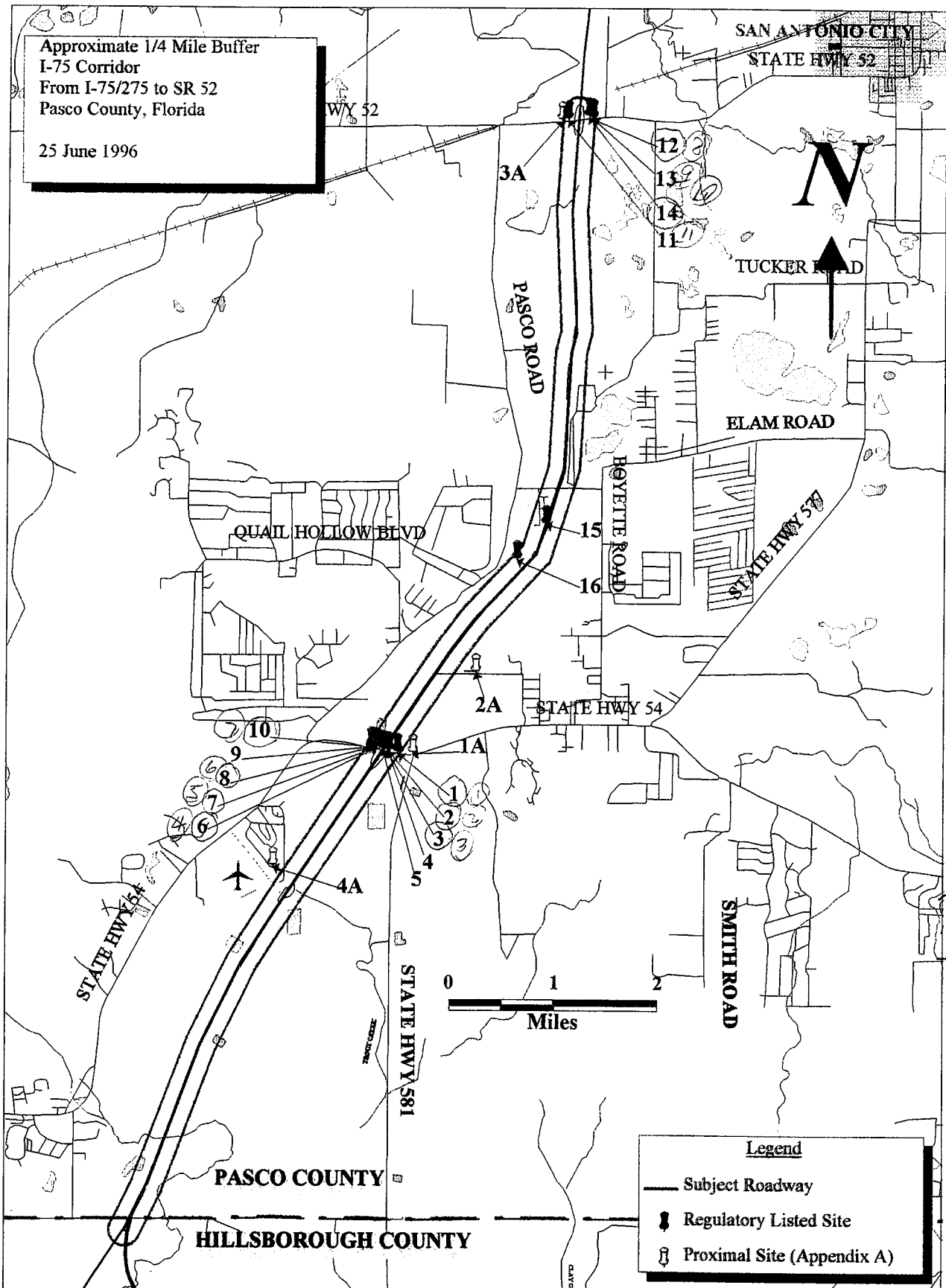

EDM

Environmental Data Management, Inc.
12360 66th Street North
Largo, Florida 34643
Tel (813) 536-8989 Fax (813) 535-9757

Map Scale and Site Locations
are Approximate

** ENVIRONMENTAL DATA MANAGEMENT **

STANDARD RADIUS REPORT

6/25/96

MASTER LIST

Page 1

REGULATORY LISTS

=====

FEDERAL / STATE

=====

	C														
N	E	E	R	R	H	F	T	/	S	S	S	P	T	H	
P	R	R	A	C	W	I	R	/	F	I	L	C	A	W	
L	C	N	A	R	D	N	I	/	A	T	D	T	N	Q	
	L	S	T	I	M	D	S	/	S	E	W	S	K	L	
	I		S	S	S	S		/		S	S		S		
	S							/		T					

APID# FACILITY ID NUMBER,
NAME AND LOCATION

- *****
- 1) 519100181
RACETRAC #407
28053 SR 54
ZEPHYRHILLS
FL 33543
X
 - 2) 518515016
OAKLEY GROVES INC
SR 54 & I-75
ZEPHYRHILLS
FL 33599
X X
 - 3) 519046575
GAS KWICK #49
28014 CR 54
WESLEY CHAPEL
FL 34249
X X
 - 3) FLD984195438
EXXON CO USA #49131
HWY 54 & I75
LAND O LAKES
FL 77210
X X
 - 4) FLD984195438
EXXON CO USA #49131
HWY 54 & I-75
LAND O LAKES
FL
X
 - 5) 93-1600
D & D SHEET METAL
HWY 54 & 75
LUTZ
FL
X
 - 6) 518515078
TILLACK & SONS INC
27829 W SR 54
WESLEY CHAPEL
FL 33543
X X
 - 6) 518515078.
CHEVRON #47128-TILLACK'S
I-75 & SR 54
WESLEY CHAPEL
FL
X X

** ENVIRONMENTAL DATA MANAGEMENT **

STANDARD RADIUS REPORT

6/25/96

MASTER LIST

Page 2

REGULATORY LISTS

=====

FEDERAL / STATE

=====

	C																	
N	E	E	R	R	H	F	T	/	S	S	S	P	T	H				
P	R	R	A	C	W	I	R	/	F	I	L	C	A	W				
L	C	N	A	R	D	N	I	/	A	T	D	T	N	Q				
	L	S	T	I	M	D	S	/	S	E	W	S	K	L				
	I		S	S	S	S		/		S	S		S					
	S							/		T								

APID# FACILITY ID NUMBER,
NAME AND LOCATION

- *****
- 7) 519201573
MASTERS ECONOMY INN
27807 SR 54
WESLEY CHAPEL FL 33543 X X
 - 8) 518520035
AMOCO #10710
15016 W HWY 54
WESLEY CHAPEL FL 34249 X X
 - 8) FLD984211425
AMOCO SVC STA #10710
27741 STATE RD 54
ZEPHYRHILLS FL 33543 X X
 - 9) FLD984254748
CIRCLE K #7475
HWY 54/I-75
ZEPHYRHILLS FL X
 - 10) 518520488
CIRCLE K #7475
HWY 54 & I-75
ZEPHYRHILLS FL 33599 X X
 - 10) FLD984254748
CIRCLE K #7475
I-75 & HIGHWAY 54
ZEPHYRHILLS FL 33619 X X
 - 11) FLD051565117.
CHEVRON USA INC DADE CITY BULK
I-75 & HWY 52
DADE CITY FL 33525 X
 - 12) 518515028
CHEVRON #47132-POLK
I-75 & SR 52
SAN ANTONIO FL 33576 X X
 - 12) 518519953
MOBIL #02-DHQ
I-75 & SR 52 W
SAN ANTONIO FL 33576 X X

** ENVIRONMENTAL DATA MANAGEMENT **

STANDARD RADIUS REPORT

6/25/96

MASTER LIST

Page 3

REGULATORY LISTS

=====

FEDERAL / STATE

=====

	C																		
N	E	E	R	R	H	F	T	/	S	S	S	P	T	H					
P	R	R	A	R	W	I	R	/	F	I	L	C	A	W					
L	C	N	A	R	D	N	I	/	A	T	D	T	N	Q					
	L	S	T	I	M	D	S	/	S	E	W	S	K	L					
	I		S	S	S	S		/		S	S		S						
	S							/		T	T								

APID# FACILITY ID NUMBER,
NAME AND LOCATION

- *****
- 12) FLD051565117
R N ROBERTS & ASSOC INC
I 75 & SR 52
DADE CITY FL 33525
X X X X
 - 13) 518520041
ROBERTS & ASSOCIATES INC
8611 SR 52
DADE CITY FL 33525
X X
 - 14) 518630460
PASCO FUEL & FOOD SHOPPE
1-75 & SR 52 STUCKEY #279
SAN ANTONIO FL 33525
X X
 - 15) 519600339
KENAN TRANSPORT CO-OVERSPILL
I-75 1/8 MI S MM/283*
WESLEY CHAPEL FL
X
 - 16) SO51-186883.
PASCO LAKES INC (C& D)
PASCO RD 28.14.00/82.14.00*
SAN ANTONIO FL
X
 - 16) SO51-254164
PASCO LAKES INC (C& D)
PASCO RD LAT/LONG 28.14.00/82.14.00*
SAN ANTONIO FL
X

UNITED STATES ENVIRONMENTAL PROTECTION AGENCY DATA

NATIONAL PRIORITIES LIST

(NPL)

The NPL is a listing of facilities and/or locations where environmental contamination has been confirmed. The NPL was devised as a method for the EPA to prioritize these sites for the purpose of taking remedial action as funded by the Hazardous Waste Substance Superfund program, which was initially established under the Comprehensive Environmental Response, Compensation and Liability Act of 1980 (CERCLA).

The EDM NPL report identifies those sites which presently appear, or have in the past appeared on the NPL.

In addition, we have included a 2 MILE SUMMARY section (Appendix B), which lists any NPL sites plotted within an approximate 2 mile radius of your requested research area. If more specific information relative to a particular site is required, please contact us and we will send you this information as an addendum to this report, at no additional cost.

Appendix C is a listing of Non-mapped sites. We recommend reviewing this section since some address information is insufficient to allow plotting within our mapping system.

**Agency File Date 6/03/96 **EDM Database updated 6/24/96



** ENVIRONMENTAL DATA MANAGEMENT **

USEPA
NATIONAL PRIORITIES LIST
(NPL)

6/25/96

=====

RAPID#	FACILITY ID NUMBER, NAME AND LOCATION	SITE INFORMATION
--------	--	---------------------

=====

NO DATA FOUND FOR THIS AREA OF STUDY

NPL STATUS:
DATE PROPOSED:
DATE FINALIZED:
SITE DISC DATE: / /

SITE CLASSIFICATION:
SITE CATEGORY:

ADDITIONAL SITE INFORMATION ¹

SITE RESPONSIBILITY:

SITE REPOSITORY:

SITE DESCRIPTION:

THREATS & CONTAMINANTS:

CLEANUP APPROACH:

RESPONSE ACTION STATUS:

ENVIRONMENTAL PROGRESS:

¹ Additional Information manually input from EPA Publication #9200.5-710B December 1992 "Superfund: Progress at National Priority List Sites".
Confirmation of this information may be obtained by contacting the EPA at (404) 347-4332

UNITED STATES ENVIRONMENTAL PROTECTION AGENCY DATA
COMPREHENSIVE ENVIRONMENTAL RESPONSE, COMPENSATION
AND LIABILITY INFORMATION SYSTEM LIST

(CERCLIS)

The CERCLIS list contains facilities and/or locations that the USEPA is investigating to determine if an existing or threatened release of hazardous substances is present. The CERCLIS list contains sites which are either proposed to or on the NPL and sites which are in the screening and assessment phase for possible inclusion on the NPL.

Once identified as a potential environmental problem, a preliminary site assessment is typically conducted by the USEPA or State agency for all sites listed on the CERCLIS list. Based upon the findings of the preliminary assessment, further assessment and remediation activities may be deemed necessary. If warranted, the site may be ranked according to the degree of environmental health and safety concerns and placed on the NPL for cleanup under the auspices of the USEPA.

As of February 15, 1995, CERCLIS no longer includes sites which the EPA has assessed and designated "No Further Remedial Action Planned" (NFRAP). A NFRAP designation means, to the best of EPA's knowledge, Superfund completed its assessment at a site and has determined no further steps to list this site on the NPL will be taken unless information indicating this decision was not appropriate or other considerations make a recommendation for listing appropriate at a later time. An NFRAP decision does not necessarily mean that there is no hazard associated with a given site; it means only that based upon available information, the location is not judged to be a potential NPL site.

Historically, even sites EPA classified as NFRAP were maintained in CERCLIS to document the evaluations took place at these sites, and to preclude the possibility they would be needlessly repeated in the future. This policy led to unintended barriers to the redevelopment of these properties and EPA decided to remove these sites from CERCLIS. NFRAP sites are archived as historical records so EPA does not needlessly repeat the investigations in the future. These NFRAP sites are being reviewed by the States in which they are located. The States will coordinate with the EPA to determine if any sites should be returned to CERCLIS because of newly identified contamination problems at the site.

The EDM CERCLIS report identifies those sites that presently appear, or have in the past appeared on the CERCLIS list. The above mentioned NFRAP sites are indicated as "HISTORICAL ENTRIES" on the EDM CERCLIS report.

Appendix B lists CERCLIS sites plotted within an approximate 2 Mile radius of your requested research area. If more specific information relative to a particular site is required, please contact us and we will send you this information as an addendum to this report, at no additional cost.

Appendix C is a listing of Non-mapped sites. We recommend reviewing this section since some address information is insufficient to allow plotting some CERCLIS sites within our mapping system.

**Agency File Date 6/03/96 **EDM Database updated EDM 6/24/96



UNITED STATES ENVIRONMENTAL PROTECTION AGENCY DATA

EMERGENCY RESPONSE NOTIFICATION SYSTEM LIST

(ERNS)

The ERNS List is intended to standardize the process of collecting, documenting and analyzing nationwide data on reported releases of oil and hazardous substances. In addition, the ERNS database records any follow-up action gathered by the Environmental Protection Agency (EPA) or the United States Coast Guard (USCG). This database is necessary to meet provisions of the revised National Oil and Hazardous Substance Pollution Contingency Plan (NCP) and to provide EPA headquarters and regional management and staff with information on the nature and types of releases occurring on a nationwide basis.

The ERNS database integrates both initial notification information of releases of oil and hazardous substances and additional follow-up information for those incidents. Information about a release is received from the reporting parties by one of three entities, the National Response Center (NRC), the EPA, or the USCG. The main ERNS database is managed by the DOT at the Transportation Systems Center in Cambridge, Massachusetts and is updated weekly by data transfers from EPA and USCG.

The EDM ERNS report is a compilation of this data from 1988 to the date of our latest quarterly update and exhibits the location and date of the reported incident, the type and quantity of materials involved and the reported response action that was taken.

In addition, we have included a 2 MILE SUMMARY section (Appendix B), which lists any ERNS sites plotted within an approximate 2 mile radius of your requested research area. If more specific information relative to a particular site is required, please contact us and we will send you this information as an addendum to this report, at no additional cost.

Appendix C is a listing of Non-mapped sites. We recommend reviewing this section since some address information is insufficient to allow plotting within our mapping system.

**Agency File Date 6/03/96 **EDM Database updated 6/25/96



** ENVIRONMENTAL DATA MANAGEMENT **

USEPA
EMERGENCY RESPONSE NOTIFICATION SYSTEM LIST
(ERNS)

6/25/96

=====

MAPID#	REGIONAL CASE # AND LOCATION OF INCIDENT	MATERIAL SPILLED	QUANTITY SPILLED	UNITS
--------	--	---------------------	---------------------	-------

=====

5	93-1600 HWY 54 & 75 LUTZ COUNTY: HILLSBOROUGH/PASCO	WASTE OIL FL	0.0	U
---	--	---------------------	-----	---

SPILL DATE: 4/21/93
REPORT DATE:
POSSIBLE RESPONSIBLE PARTY: D & D SHEET METAL
SPILL INFO:

ACTION TAKEN: NONE
COMMENTS:

UNITED STATES ENVIRONMENTAL PROTECTION AGENCY DATA

RCRA ADMINISTRATIVE ACTION TRACKING SYSTEM LIST

(RAATS)

The RAATS list identifies those facilities that are currently or at one time were subject to EPA enforcement for activities relative to their handling of hazardous wastes. The appearance of a site on this list does not necessarily indicate environmental degradation on the site, but rather that the facility was cited by the EPA for violation of laws regarding hazardous waste handling activities. These violations may present the potential to cause environmental degradation if hazardous wastes have been mishandled or otherwise released in an uncontrolled manner.

A brief explanation of the codes exhibited on the RAATS report is presented below. Appendix C is a listing of Non-mapped sites. We recommend reviewing this section since some address information is insufficient to allow plotting within our mapping system.

EXPLANATION OF CODES

ACTION TYPE:

01 = 3008 (A)	11 = NOTICE OF VIOLATION
06 = 9006	12 = 9003
08 = 3008 (H)	13 = LETTER OF WARNING
09 = 3013	14 = NOTICE OF NON-COMPLIANCE
10 = 7003	17 = MEDICAL WASTE

STATUS CODE:

01 = COMPLAINT ISSUED
02 = CONSENT AGREEMENT/FINAL ORDER
03 = ALJ DECISION
05 = WITHDRAWAL/DISMISSAL
08 = CORRECTIVE ACTION
09 = UNILATERAL ORDER
11 = NOTICE OF VIOLATION
16 = FINALIZED - NO CAFO
19 = INITIAL ACTION
20 = FEDERAL FACILITY COMPLIANCE AGREEMENT

VIOLATION TYPE:

P = PERMIT
R = RCRA
C = CODE OF FEDERAL REGULATIONS (CFR)
S = STATE STATUTES

**Database last updated by EDM 8/26/95



** ENVIRONMENTAL DATA MANAGEMENT **

USEPA
RCRA ADMINISTRATIVE ACTION TRACKING SYSTEM LIST
(RAATS)

6/25/96

RAPID#

```
=====
FACILITY ID NUMBER,          ACTION ID   ACTION   STATUS
NAME AND LOCATION           NUMBER     CODE     CODE
=====
```

NO DATA FOUND FOR THIS AREA OF STUDY

ISSUE DATE:

FINAL DATE:

PROPOSED PENALTY:

FINAL PENALTY:

VIOLATIONS NOTED/VIOLATION TYPE:

COMMENTS:

UNITED STATES ENVIRONMENTAL PROTECTION AGENCY DATA
RESOURCE CONSERVATION AND RECOVERY INFORMATION SYSTEM LIST
(RCRIS)

The RCRIS list identifies those facilities or locations that have notified the EPA of their activities relative to the handling of hazardous wastes. The appearance of a site on this list does not necessarily indicate environmental problems on the site, but rather that the site is (or was) engaged in hazardous waste handling activities and therefore may have the potential to cause environmental degradation if hazardous wastes have been mishandled or otherwise released in an uncontrolled manner.

Each site exhibited on the EDM RCRIS report will have its status (i.e. Generator, Transporter or TSD) indicated beneath the Facility Name and Location information.

Appendix C is a listing of Non-mapped sites. We recommend reviewing this section since some address information is insufficient to allow plotting within our mapping system.

**Agency File Date 3/01/96 **EDM Database updated 4/08/96



UNITED STATES ENVIRONMENTAL PROTECTION AGENCY DATA

FACILITY INDEX SYSTEM

(FINDS)

The FINDS list identifies facilities and/or locations that are subject to regulation under certain EPA programs, due to operations conducted at these sites. The appearance of a site on this list does not necessarily indicate environmental problems on the site, but rather that the site conducts operations that may have a potential to cause environmental degradation if hazardous compounds are released in an uncontrolled manner.

Each site exhibited on the EDM FINDS report will have an "X" beneath one or more of the source indicators shown on the right side of the report. These source indicators denote which EPA program, such as Air, Water or Hazardous Waste, is responsible for regulating the activities conducted on the site. The "Explanation of Codes" table exhibited below, shows each source indicator and the corresponding EPA office responsible for regulating these activities.

Appendix C is a listing of Non-mapped sites. We recommend reviewing this section since some address information is insufficient to allow plotting within our mapping system.

EXPLANATION OF CODES

SOURCE INDICATOR	DESCRIPTION OF SOURCE	EPA PROGRAM OFFICE
*RCRIS	RCRA INFORMATION SYSTEM	WASTE-RCRA
*PCS	PERMIT COMPLIANCE SYSTEM	WATER
*AFS	COMPLIANCE DATA & AIR FAC.	AIR ENFORCEMENT
*SSTS	PESTICIDES & TSCA ENFORCEMENT SYSTEM	AIR-PESTICIDES
*CERCLIS	SUPERFUND-HAZARDOUS WASTE SITES	WASTE-SUPERFUND
*FTTS	PESTICIDES & TOXIC SUBSTANCE	TSCA
*DOCKET	ENFORCEMENT & COMPLIANCE MONITORING SYSTEM	REGIONAL COUNSEL
*CONTROL	HAZARDOUS WASTE CONTROL TECHNOLOGY	HQ-EPA, ORC, & OSW
*CRIM DOC	CHEMICAL DOCKET SYSTEM	ORC
*FFIS	FEDERAL FACILITY INFORMATION SYSTEM	FEDERAL FACILITIES
*CICIS	CHEMICALS IN COMMERCE INFORMATION SYSTEM	TSCA
*STATE	STATE SYSTEM	STATE OFFICES
*PADS	PCB ACTIVITY DATA SYSTEM	TSCA
*RCRA-J	MEDICAL WASTE UNDER RCRA	WASTE-RCRA
*TRIS	TOXIC RELEASE INVENTORY SYSTEM	TSCA-AIR TOXICS
*CUS	CHEMICAL UPDATE SYSTEM	TSCA

For more information on sites identified under these programs you may contact the USEPA Region IV office at (404) 347-4332.

**Agency File Date 6/03/96 **EDM Database updated 6/21/96



UNITED STATES ENVIRONMENTAL PROTECTION AGENCY DATA

TOXIC RELEASE INVENTORY SYSTEM LIST

(TRIS)

The TRIS list identifies those facilities that are required to submit annual reports relative to the estimated release of toxic chemicals to the environment, as stipulated under section 313 of the Emergency Planning and Community Right-to-Know Act (EPCRA, or Title III of the Superfund Amendment and Reauthorization Act of 1986). This reporting is required to provide the public with information on the release of listed toxic chemicals in their communities and to provide the EPA with release information to assist the Agency in determining the need for future regulations. Facilities subject to these provisions must report the quantities of both routine and accidental releases of listed toxic chemicals.

The EDM TRIS report includes general information on the facility as well as specific information on the listed chemical(s), including its use and maximum amount stored on-site; the estimated quantity released to air, water, land or injected underground; and the amounts transferred to off-site locations.

The appearance of a facility on this list does not necessarily indicate environmental degradation on the site, but rather that listed toxic chemicals are in use and released from the site.

Appendix C, is a listing of Non-mapped sites. We recommend reviewing this section since some address information is insufficient to allow plotting within our mapping system.

**Database last updated 10/29/94



ENVIRONMENTAL DATA MANAGEMENT

USEPA
TOXIC RELEASE INVENTORY SYSTEM LIST
(TRIS)

6/25/96

MAPID#

=====

GENERAL INFORMATION

NO DATA FOUND FOR THIS AREA OF STUDY

EPA ID NO:
NFDES NO:
FAC D&B NO:
SIC CODE:
SIC CODE DESCRIPTION:

CONTACT:
PARENT COMPANY:

PARENT COMPANY D&B NO:

*****TRIS SUBSTANCE DETAILS*****

TRIS FACILITY ID NO:
NAME OF SUBSTANCE:
GENERIC NAME:
CASRN NO:

EPA SUBMISSION NO:

***** REPORTING YEAR: *****

RELEASE INFORMATION

=====

MAY ON SITE:
USE OF SUBSTANCE:

NON-POINT AIR RELEASE (LBS):
DISCHARGE TO RECEIVING WATERS (LBS):
& DISCHARGE AS STORMWATER:
LAND RELEASE ON-SITE (LBS):
TRANSFER TO OFF-SITE POTW (LBS):
POTW NAME:
POTW ADDRESS:
POTW CITY:
POTW STATE:

POINT AIR RELEASE (LBS):
NAME OF RECEIVING WATERS:
UNDERGROUND RELEASE:
LAND DISPOSAL:

TRANSFER TO OTHER OFF-SITE LOCATION (LBS):
OFF-SITE EPA ID NO:
OFF-SITE NAME:
OFF-SITE ADDRESS:
OFF-SITE CITY:
OFF-SITE STATE:

GENERAL WASTESTREAM:
TREATMENT METHOD:

=====

ON-SITE TREATMENT INFORMATION

=====

UNITED STATES ENVIRONMENTAL PROTECTION AGENCY DATA

HAZARDOUS WASTE DATA MANAGEMENT SYSTEM LIST

(HWDMS)

The HWDMS list is a historical database once maintained by the USEPA which identifies those facilities or locations that have notified the EPA of their activities relative to the handling of hazardous wastes. The appearance of a site on this list does not necessarily indicate environmental problems on the site, but rather that the site is (or was) engaged in hazardous waste handling activities and therefore may have the potential to cause environmental degradation if hazardous wastes have been mishandled or otherwise released in an uncontrolled manner.

Each site exhibited on the EDM HWDMS report will have its status (i.e. Generator, Transporter, TSD, etc...) indicated beneath the Facility Name and Location information on the report.

Appendix C is a listing of Non-mapped sites. We recommend reviewing this section since some address information is insufficient to allow plotting within our mapping system.

*The HWDMS list is no longer an active database and has been replaced by the RCRIS list. HWDMS last updated by EDM 2/01/91



** ENVIRONMENTAL DATA MANAGEMENT **

USEPA
HAZARDOUS WASTE DATA MANAGEMENT
SYSTEM LIST
(HWDMS)

=====

MAPID#	FACILITY ID NUMBER, NAME AND LOCATION	FACILITY STATUS	PERMIT STATUS
--------	--	--------------------	------------------

=====

--HISTORICAL DATABASE--

12 FLD051565117
CHEVRON USA INC DADE CITY BUL*
I-75 & HWY 52
DADE CITY FL 33525

GENERATOR STATUS: NOT A GENERATOR
TRANSPORTER STATUS:
TSD STATUS:
UNDERGROUND INJECTION STATUS:
INTERIM STATUS:

STATE OF FLORIDA DEPARTMENT OF ENVIRONMENTAL PROTECTION

STATE FUNDED ACTION SITES

(SFAS)

The Florida SFAS list contains facilities and/or locations that have been identified by the FDEP as having known environmental contamination and are currently being addressed through State funded cleanup action.

The SFAS list contains information on which FDEP District office has taken the lead role in overseeing the assessment and cleanup activities required for a site, the Project Manager responsible for the site, the last known Status of the site and the type of activity that is or was conducted on the site.

In addition, we have included a 2 MILE SUMMARY section (Appendix B), which lists all identified SFAS sites within an approximate 2 mile radius of your requested research area. If more specific information relative to a particular location is desired, please feel free to contact us and we will send you this information as an addendum to this report, at no additional cost.

Appendix C is a listing of Non-mapped sites. We recommend reviewing this section since some address information is insufficient to allow plotting within our mapping system.

**Agency File Date 8/24/95 **EDM Database Updated 3/15/96

STATE OF FLORIDA DEPARTMENT OF ENVIRONMENTAL PROTECTION

FLORIDA SITES LIST

(SITES)

The Florida Sites list contains facilities and/or locations that have been identified by the FDEP as having known or suspected environmental contamination. According to sources at the FDEP, this list has not been updated since 1989.

The SITES list contains information on which agency (FDEP, EPA or local) has taken the lead role in overseeing the assessment and cleanup activities required for a site as well as the project manager who is responsible for the site. The "Explanation of Codes" exhibited below identifies the codes that are used to designate the lead and support agencies relative to the activities being conducted on each site.

In addition, we have included a 2 MILE SUMMARY section (Appendix B), which lists all identified SITES facilities within an approximate 2 mile radius of your requested research area. If more specific information relative to a particular location is desired, please feel free to contact us and we will send you this information as an addendum to this report, at no additional cost.

Appendix C is a listing of Non-mapped sites. We recommend reviewing this section since some address information is insufficient to allow plotting within our mapping system.

EXPLANATION OF CODES

FLORIDA SITES LIST
LEAD UNITS AND/OR SUPPORT UNITS

DIST = FDEP DISTRICT OFFICE (i.e. SOUTHWEST, CENTRAL, ETC....)

EPA = ENVIRONMENTAL PROTECTION AGENCY REGIONAL OFFICE

BWC = FDEP BUREAU OF WASTE CLEANUP

OGC = FDEP OFFICE OF GENERAL COUNCIL

LOCAL = LOCAL AGENCY (i.e. MUNICIPALITY OR COUNTY)

DERM = DADE COUNTY DEPARTMENT OF ENVIRONMENTAL RESOURCES
MANAGEMENT

GW = FDEP GROUNDWATER SECTION

3012 = EPA/CERCLA SITE SCREENING SECTION

**Database last updated by EDM 3/29/95



STATE OF FLORIDA DEPARTMENT OF ENVIRONMENTAL PROTECTION

*
SOLID WASTE FACILITIES

(SLDWST)

The SOLID WASTE FACILITIES list identifies locations that have been permitted to conduct solid waste landfilling activities or other waste handling activities such as those conducted at transfer stations. In addition, sites handling Bio-hazardous wastes are also included on this list. The appearance of a site on this list does not necessarily indicate environmental problems at the site, but rather that the site handles solid or Bio-hazardous wastes that could pose an environmental concern if, as a result of an uncontrolled release, hazardous compounds were able to impact the environment. The EDM SOLID WASTE FACILITIES r identifies those sites which presently appear, or have in the past appeared, on this list.

In addition, we have included a 2 MILE SUMMARY section (Appendix B), which lists all plotted SOLID WASTE sites within an approximate 2 mile radius of your requested research area. If you require specific information relative to any of the sites appearing on this list, please contact us and we will supply you with this information as an addendum to this report, at no additional cost.

Appendix C is a listing of Non-mapped sites. We recommend reviewing this section since some address information is insufficient to allow plotting within our mapping system.

* Sites having ## after the Permit Number were obtained from documents on record at the Tampa Bay Regional Planning Council offices.

**Agency File Date 2/21/96 **EDM Database updated 3/15/96



PRODUCT CODES CONT'D

M = FUEL OIL ON SITE HEAT	N = FUEL OIL-DISTRIBUTION
O = NEW/LUBE OIL	P = GENERIC GAS
Q = PESTICIDE	R = AMMONIA COMPOUND
S = CHLORINE COMPOUND	T = HAZARDOUS SUBSTANCE
U = MINERAL ACID	V = BUNKER "C" RESIDUAL OIL
W = PETROLEUM ADDITIVE	X = MISC PETROL-BASE PRODUCT
Y = UNKNOWN/NOT REPORTED	Z = OTHER

CONSTRUCTION TYPE CODES

A = OVERFILL-BALL CHECK	B = INTERIOR LINED STEEL
C = BARE/ASPHALT COATED STEEL	D = UNKNOWN/NOT REPORTED
E = FIBERGLASS	F = FRP CLAD STEEL
G = CATH PROT-SAC ANODE	H = CATH PROT-IMP CURR
I = DBL WALL=PRIMARY MATL	J = UST SYNTHETIC LINER
K = AST CONTAINMENT AREA	L = COMPARTMENTED
M = SPILL CONTAINMENT	N = OP-FLOW SHUT OFF
O = OP-TIGHT FILL	P = LEVEL GAUGES/HI LEVEL ALARMS
Q = APPV ALT OVERFILL	R = DBLWALL=2ND MATERIAL
S = APPV ALT CONTAINMENT	T = SMALL USE TANK
U = FIELD ERECTED	W = BUILT ON SUPPORTS
X = CONCRETE	Y = POLYETHYLENE
Z = APPROVED ALTERNATE SYSTEM	

PIPING TYPE CODES

A = ABVGRND-NO CONTACT W/SOIL	B = UNPROTECTED METAL
C = FIBERGLASS	D = CORROSION RESISTANT COATING
E = CATHODIC PROTECTION (STEEL)	F = DBLWALL=PRIMARY MATL
G = SECONDARY CONTAINMENT	H = AIRPORT/SEAPORT HYDRANT
I = SUCTION PIPING	J = PRESSURIZED PIPING
K = DISPENSER LINER	L = BULK PRODUCT PIPE
M = DBLWALL=2ND MATERIAL	N = APPV SYNTHETIC MATERIAL
V = VIOLATION	Y = UNKNOWN/NOT REPORTED
Z = APPROVED ALTERNATE MATERIAL	

LEAK MONITORING CODES

A = AUTOMATICALLY SAMPLED WELLS	B = MANUALLY SAMPLED WELLS
C = GROUNDWATER MONITOR PLAN	D = SPCC PLAN
E = TANK LINER SPACE	F = DW TANK SPACE
G = PIPING/AUTO SHUTOFF	H = PIPING/FLOW RESTRICTOR
I = NOT REQUIRED	J = PIPING LINER SPACE
K = DW PIPING SPACE	L = AUTO TANK GAUGING
M = MANUAL TANK GAUGING	N = GROUNDWATER MONITORING
O = VAPOR MONITORING	X = NONE
Y = UNKNOWN/NOT REPORTED	Z = APPROVED ALTERNATE SYSTEM

DISPOSAL METHOD CODES

A = CLOSED IN PLACE	B = REMOVED
F = UNMAINTAINED	T = TEMP OUT OF SERVICE
U = IN SERVICE	

TANK CONTENTS CATEGORY

H = HAZARDOUS/OTHER	P = POLLUTANT	V = VEHICULAR
---------------------	---------------	---------------

**Agency File Date 2/28/96 ** EDM Database updated 4/02/96



** ENVIRONMENTAL DATA MANAGEMENT **

FDEP
STATIONARY TANK INVENTORY SYSTEM LIST
(TANKS)

6/25/96

RAPID#

FACILITY ID NO,
NAME AND LOCATION

OWNERSHIP INFORMATION

1

519100181
RACETRAC #407
28053 SR 54
ZEPHYRHILLS FL 33543

RACETRAC PETROLEUM INC
PO BOX 105035
ATLANTA GA 303485035

FACILITY OPERATOR: RACETRAC PETROLEUM INC
FACILITY TEL NO: 2059916199

OWNER CONTACT: STEVE EMORY
OWNER TEL NO: 4044317600

FACILITY TYPE: A FACILITY STATUS: O CONTAMINATION REPORTED? (Y/N): N

TANK NO.	TANK VOLUME (GALS)	DATE INSTALLED	PRODUCT TYPE	A/U GROUND	CONSTR TYPE	PIPING TYPE	LEAK MONITORING	DISPOSAL METHOD	DATE LAST USED	TANK CONTENTS CATEGORY
1	00012000	12/90	C	U	AIMNO	CFGJK	FHKL	U	/	V
2	00012000	12/90	C	U	AIMNO	CFGJK	FHKL	U	/	V

** ENVIRONMENTAL DATA MANAGEMENT **

FDEP
STATIONARY TANK INVENTORY SYSTEM LIST
(TANKS)

6/25/96

RAPID#

FACILITY ID NO,
NAME AND LOCATION

OWNERSHIP INFORMATION

2

518515016
OAKLEY GROVES INC
SR 54 & I-75
ZEPHYRHILLS FL 33599

OAKLEY GROVES INC
PO BOX 4170
LAKE WALES FL 338594170

FACILITY OPERATOR: OAKLEY RONALD E
FACILITY TEL NO: 8139731087

OWNER CONTACT: RONALD E OAKLEY
OWNER TEL NO: 8136381435

FACILITY TYPE: M FACILITY STATUS: C CONTAMINATION REPORTED? (Y/N): Y

TANK NO.	TANK VOLUME (GALS)	DATE INSTALLED	PRODUCT TYPE	A/U GROUND	CONSTR TYPE	PIPING TYPE	LEAK MONITORING	DISPOSAL METHOD	DATE LAST USED	TANK CONTENTS CATEGORY
1	00010000	11/82	D	U	AC	B	B	F	06/91	V
2	00010000	11/82	B	U	AC	B	B	F	06/91	V
3	00010000	11/82	B	U	AC	B	B	F	06/91	V
4	00010000	11/82	A	U	AC	B	B	F	06/91	V

** ENVIRONMENTAL DATA MANAGEMENT **

FDEP
STATIONARY TANK INVENTORY SYSTEM LIST
(TANKS)

6/25/96

RAPID#

FACILITY ID NO,
NAME AND LOCATION

OWNERSHIP INFORMATION

3

519046575
GAS KWICK #49
28014 CR 54
WESLEY CHAPEL FL 34249

RADIANT OIL CO OF TAMPA INC
PO BOX 5238
TAMPA FL 336755238

FACILITY OPERATOR: RADIANT OIL CO OF TAMPA IN OWNER CONTACT: JOHN P MYERS JR
FACILITY TEL NO: 8132474731 OWNER TEL NO: 8132474731

FACILITY TYPE: A FACILITY STATUS: O CONTAMINATION REPORTED? (Y/N): Y

TANK NO.	TANK VOLUME (GALS)	DATE INSTALLED	PRODUCT TYPE	A/U GROUND	CONSTR TYPE	PIPING TYPE	LEAK MONITORING	DISPOSAL METHOD	DATE LAST USED	TANK CONTENTS CATEGORY
1	00010000	05/90	B	U	FMNO	CFJ	BHL	U	/	V
2	00010000	05/90	B	U	FMNO	FHJ	BHL	U	/	V
3	00010000	05/90	B	U	FMNO	CFJ	BHL	U	/	V

** ENVIRONMENTAL DATA MANAGEMENT **

FDEP
STATIONARY TANK INVENTORY SYSTEM LIST
(TANKS)

6/25/96

MAPID#

FACILITY ID NO,
NAME AND LOCATION

OWNERSHIP INFORMATION

6

518515078
TILLACK & SONS INC
27829 W SR 54
WESLEY CHAPEL FL 33543

TILLACK & SONS INC
27829 W SR 54
WESLEY CHAPEL FL 33543

FACILITY OPERATOR: JACK A TILLACK
FACILITY TEL NO: 8139730133

OWNER CONTACT: JACK A TILLACK
OWNER TEL NO: 8139730133

FACILITY TYPE: A FACILITY STATUS: O CONTAMINATION REPORTED? (Y/N): Y

TANK NO.	TANK VOLUME (GALS)	DATE INSTALLED	PRODUCT TYPE	A/U GROUND	CONSTR TYPE	PIPING TYPE	LEAK MONITORING	DISPOSAL METHOD	DATE LAST USED	TANK CONTENTS CATEGORY
1	00010000	XX/79	D	U	AEMN	CJ	BHN	U	/	V
2	00010000	XX/83	B	U	AEMN	CJ	BHN	U	/	V
3	00010000	XX/83	B	U	AEMN	CJ	BHN	U	/	V
4	00010000	XX/83	B	U	AEMN	CJ	BHN	U	/	V
5	00001000	01/83	L	U	E	C	Y	B	XX/91	P

** ENVIRONMENTAL DATA MANAGEMENT **

FDEP
STATIONARY TANK INVENTORY SYSTEM LIST
(TANKS)

6/25/96

MAPID#

FACILITY ID NO,
NAME AND LOCATION

OWNERSHIP INFORMATION

--HISTORICAL ENTRY--

518515078.
CHEVRON #47128-TILLACK'S
I-75 & SR 54
WESTLEY CHAPEL FL

CHEVRON USA PRODUCTS CO
PO BOX 1706
ATLANTA
GA 303011706

FACILITY OPERATOR: TILLACK J
FACILITY TEL NO: 8139730133

OWNER CONTACT: CHERYL TENNEYCK
OWNER TEL NO: 40498443000

FACILITY TYPE: A

FACILITY STATUS: O

CONTAMINATION REPORTED? (Y/N): Y

TANK NO.	TANK VOLUME (GALS)	INSTALLED DATE	PRODUCT TYPE	A/U GROUND	CONSTR TYPE	PIPING TYPE	LEAK MONITORING	DISPOSAL METHOD	TANK DATE	LAST CONTENTS	USED CATEGORY
1	00010000	XX/79	D	U	AEMN	CT	BHN	U	/	V	
2	00010000	XX/83	B	U	AEMN	CT	BHN	U	/	V	
3	00010000	XX/83	B	U	AEMN	CT	BHN	U	/	V	
4	00010000	XX/83	B	U	AEMN	CT	BHN	U	/	V	
5	00001000	01/83	L	U	E	C	X	B	XX/91	P	

** ENVIRONMENTAL DATA MANAGEMENT **

FDEP
STATIONARY TANK INVENTORY SYSTEM LIST
(TANKS)

6/25/96

RAPID#

FACILITY ID NO,
NAME AND LOCATION

OWNERSHIP INFORMATION

7

519201573
MASTERS ECONOMY INN
27807 SR 54
WESLEY CHAPEL FL 33543

HLC PROPERTIES INC
PO BOX 13069
SAVANNAH GA 31416

FACILITY OPERATOR: HLC PROPERTIES INC
FACILITY TEL NO: 8139730155

OWNER CONTACT: MAX C RISTER
OWNER TEL NO: 9123524493

FACILITY TYPE: C FACILITY STATUS: C CONTAMINATION REPORTED? (Y/N): Y

TANK NO.	TANK VOLUME (GALS)	DATE INSTALLED	PRODUCT TYPE	A/U GROUND	CONSTR TYPE	PIPING TYPE	LEAK MONITORING	DISPOSAL METHOD	DATE LAST USED	TANK CONTENTS CATEGORY
----------	--------------------	----------------	--------------	------------	-------------	-------------	-----------------	-----------------	----------------	------------------------

NONE

** ENVIRONMENTAL DATA MANAGEMENT **

FDEP
STATIONARY TANK INVENTORY SYSTEM LIST
(TANKS)

6/25/96

APID#

FACILITY ID NO,
NAME AND LOCATION

OWNERSHIP INFORMATION

8

518520035
AMOCO #10710
15016 W HWY 54
WESLEY CHAPEL FL 34249

AMOCO PETROLEUM PRODUCTS
600 CORPORATE DR #500
FORT LAUDERDALE FL 333343607

FACILITY OPERATOR: AMOCO OIL CO
FACILITY TEL NO: 8136542880

OWNER CONTACT: ROBERT HERRICK
OWNER TEL NO: 8136542880

FACILITY TYPE: FACILITY STATUS: 0 CONTAMINATION REPORTED? (Y/N): Y

TANK NO.	TANK VOLUME (GALS)	DATE INSTALLED	PRODUCT TYPE	A/U GROUND	CONSTR TYPE	PIPING TYPE	LEAK MONITORING	DISPOSAL METHOD	DATE LAST USED	TANK CONTENTS CATEGORY
1	00010000	06/84	B	U	GMO	EJ	BHL	U	/	V
2	00010000	06/84	B	U	GMO	EJ	BHL	U	/	V
3	00010000	06/84	B	U	GMO	EJ	BHL	U	/	V
4	00010000	06/84	D	U	GMO	EJ	BHL	U	/	V

** ENVIRONMENTAL DATA MANAGEMENT **

FDEP
STATIONARY TANK INVENTORY SYSTEM LIST
(TANKS)

6/25/96

APID#

FACILITY ID NO,
NAME AND LOCATION

OWNERSHIP INFORMATION

10

518520488
CIRCLE K #7475
HWY 54 & I-75
ZEPHYRHILLS FL 33599

CIRCLE K STORES INC
5650 BRECKENRIDGE PARK DR #300
TAMPA FL 33610

FACILITY OPERATOR: CIRCLE K CORP
FACILITY TEL NO: 8136898161

OWNER CONTACT: STEVE BELIN
OWNER TEL NO: 8137445266

FACILITY TYPE: A FACILITY STATUS: O CONTAMINATION REPORTED? (Y/N): Y

TANK NO.	TANK VOLUME (GALS)	DATE INSTALLED	PRODUCT TYPE	A/U GROUND	CONSTR TYPE	PIPING TYPE	LEAK MONITORING	DISPOSAL METHOD	DATE LAST USED	TANK CONTENTS CATEGORY
1	00010000	07/85	B	U	GMO	CJ	BHO	U	/	V
2	00010000	07/85	B	U	GMO	CJ	BHO	U	/	V
3	00010000	07/85	B	U	GMO	CJ	BHO	U	/	V
4	00010000	07/85	D	U	GMO	CJ	BHO	U	/	V

** ENVIRONMENTAL DATA MANAGEMENT **

FDEP
STATIONARY TANK INVENTORY SYSTEM LIST
(TANKS)

6/25/96

LAPID#

FACILITY ID NO,
NAME AND LOCATION

OWNERSHIP INFORMATION

12

518519953
MOBIL #02-DHQ
I-75 & SR 52 W
SAN ANTONIO FL 33576

MOBIL OIL CORP
PO BOX 142667
AUSTIN TX 787142667

FACILITY OPERATOR: MOBIL OIL CORP
FACILITY TEL NO:

OWNER CONTACT: CLIFF L ROWELL
OWNER TEL NO: 7038462042

FACILITY TYPE: A FACILITY STATUS: C CONTAMINATION REPORTED? (Y/N): Y

TANK NO.	TANK VOLUME (GALS)	DATE INSTALLED	PRODUCT TYPE	A/U GROUND	CONSTR TYPE	PIPING TYPE	LEAK MONITORING	DISPOSAL METHOD	DATE LAST USED	TANK CONTENTS CATEGORY
1	00003000	10/66	A	U	AC	B	BH	B	09/85	V
1R1	00010000	09/85	D	U	AE	C	BH	B	01/91	V
2	00003000	10/66	A	U	AC	B	BH	B	09/85	V
2R1	00010000	09/85	B	U	AE	C	BH	B	01/91	V
3	00003000	10/66	A	U	AC	B	BH	B	09/85	V
3R1	00010000	09/85	B	U	AE	C	BH	B	01/91	V
4	00010000	06/72	B	U	AC	B	BH	B	09/85	V
4R1	00010000	09/85	A	U	AE	C	BH	B	01/91	V
5	00003000	10/66	B	U	AC	B	BH	B	09/85	V
6	00003000	10/66	B	U	AC	B	BH	B	09/85	V
7	00003000	01/66	D	U	AC	B	BH	B	09/85	V
8	00001000	09/85	L	U	AE	C	I	B	11/90	P

** ENVIRONMENTAL DATA MANAGEMENT **

FDEP
STATIONARY TANK INVENTORY SYSTEM LIST
(TANKS)

6/25/96

MAPID#

FACILITY ID NO,
NAME AND LOCATION

OWNERSHIP INFORMATION

12

518515028
CHEVRON #47132-POLK
I-75 & SR 52
SAN ANTONIO FL 33576

CHEVRON USA PRODUCTS CO
PO BOX 1706
ATLANTA GA 303011706

FACILITY OPERATOR: POLK I
FACILITY TEL NO: 9045882782

OWNER CONTACT: CHERYL TENEYCK
OWNER TEL NO: 7709843000

FACILITY TYPE: A FACILITY STATUS: C CONTAMINATION REPORTED? (Y/N): Y

TANK NO.	TANK VOLUME (GALS)	DATE INSTALLED	PRODUCT TYPE	A/U GROUND	CONSTR TYPE	PIPING TYPE	LEAK MONITORING	DISPOSAL METHOD	DATE LAST USED	TANK CONTENTS CATEGORY
1	00010000	XX/70	A	U	C	B	Y	B	/	V
1R1	00010000	01/86	B	U	AE	C	BH	B	03/91	V
2	00004000	XX/66	B	U	C	B	Y	B	/	V
2R1	00010000	01/86	B	U	AE	C	BH	B	03/91	V
3	00003000	XX/66	B	U	C	B	Y	B	/	V
3R1	00010000	01/86	B	U	AE	C	BH	B	03/91	V
4	00002000	XX/66	B	U	C	B	Y	B	/	V
4R1	00001000	01/86	Z	U	AE	C	BH	B	03/91	H
5	00002000	XX/66	B	U	C	B	Y	B	/	V
6	00000550	XX/66	Z	U	C	B	Y	B	XX/XX	H

** ENVIRONMENTAL DATA MANAGEMENT **

FDEP
STATIONARY TANK INVENTORY SYSTEM LIST
(TANKS)

6/25/96

RAPID#

FACILITY ID NO,
NAME AND LOCATION

OWNERSHIP INFORMATION

13

518520041
ROBERTS & ASSOCIATES INC
8611 SR 52
DADE CITY FL 33525

R N ROBERTS & ASSOCIATES INC
33233 ST JOE RD
DADE CITY FL 33525

FACILITY OPERATOR: ROBERTS DAVID D
FACILITY TEL NO: 9043573339

OWNER CONTACT: DAVID D ROBERTS
OWNER TEL NO: 9045675873

FACILITY TYPE: C FACILITY STATUS: C CONTAMINATION REPORTED? (Y/N): Y

TANK NO.	TANK VOLUME (GALS)	DATE INSTALLED	PRODUCT TYPE	A/U GROUND	CONSTR TYPE	PIPING TYPE	LEAK MONITORING	DISPOSAL METHOD	DATE LAST USED	TANK CONTENTS CATEGORY
1	00001000	01/77	B	U	C	B	B	B	XX/92	V
10	00002000	01/77	O	A	C	A	B	B	XX/92	P
2	00001000	01/77	B	U	C	B	B	B	XX/92	V
3	00012000	01/77	K	U	C	B	B	B	XX/92	P
4	00020000	01/77	H	U	C	B	B	B	XX/92	P
5	00002000	01/77	B	U	C	B	B	B	XX/92	V
6	00020000	01/77	B	U	C	B	B	B	XX/92	V
7	00020000	01/77	B	U	C	B	B	B	XX/92	V
8	00020000	01/77	B	U	C	B	B	B	XX/92	V
9	00004000	01/80	H	U	C	B	B	B	XX/92	P

** ENVIRONMENTAL DATA MANAGEMENT **

FDEP
STATIONARY TANK INVENTORY SYSTEM LIST
(TANKS)

6/25/96

RAPID#

FACILITY ID NO,
NAME AND LOCATION

OWNERSHIP INFORMATION

14

518630460
PASCO FUEL & FOOD SHOPPE
1-75 & SR 52 STUCKEY #279
SAN ANTONIO FL 33525

WARECO SYSTEM OF IOWA INC %WARE
PO BOX 1287
JACKSONVILLE IL 626511287

FACILITY OPERATOR: PASCO FUEL & FOOD SHOPPE
FACILITY TEL NO: 9047873315

OWNER CONTACT: TODD R WARE
OWNER TEL NO: 2172459528

FACILITY TYPE: A FACILITY STATUS: O CONTAMINATION REPORTED? (Y/N): Y

TANK NO.	TANK VOLUME (GALS)	DATE INSTALLED	PRODUCT TYPE	A/U GROUND	CONSTR TYPE	PIPING TYPE	LEAK MONITORING	DISPOSAL METHOD	DATE LAST USED	TANK CONTENTS CATEGORY
1	00006000	03/75	B	U	ABCMO	CJK	BHMN	U	/	V
2	00010000	05/72	B	U	ABCMO	CJK	BHMN	U	/	V
3	00010000	05/72	B	U	ABCMO	CJK	BHMN	U	/	V
4	00008000	03/87	D	U	AEMO	CJK	BHMN	U	/	V

** ENVIRONMENTAL DATA MANAGEMENT **

FDEP
STATIONARY TANK INVENTORY SYSTEM LIST
(TANKS)

6/25/96

APID#

FACILITY ID NO,
NAME AND LOCATION

OWNERSHIP INFORMATION

15

519600339
KENAN TRANSPORT CO-OVERSPILL
I-75 1/8 MI S MM/283
WESLEY CHAPEL FL

KENAN TRANSPORT CO % BOB JAYNE
PO BOX 2729
CHAPEL HILL NC 275152729

FACILITY OPERATOR:
FACILITY TEL NO:

OWNER CONTACT: ROBERT K JAYNE
OWNER TEL NO: 9199678221

FACILITY TYPE: X FACILITY STATUS: C CONTAMINATION REPORTED? (Y/N): Y

TANK NO.	TANK VOLUME (GALS)	DATE INSTALLED	PRODUCT TYPE	A/U GROUND	CONSTR TYPE	PIPING TYPE	LEAK MONITORING	DISPOSAL METHOD	DATE LAST USED	TANK CONTENTS CATEGORY
----------	--------------------	----------------	--------------	------------	-------------	-------------	-----------------	-----------------	----------------	------------------------

NONE /

STATE OF FLORIDA DEPARTMENT OF ENVIRONMENTAL PROTECTION

HAZARDOUS WASTE QUICK LOOK REPORT

(HWQL)

The HWQL Report identifies facilities and/or locations that have notified the FDEP of their activities relative to the handling of hazardous wastes. The appearance of a site on this list does not necessarily indicate environmental problems at the site, but rather that the site is (or was) engaged in the handling of hazardous wastes, which if improperly managed or released in an uncontrolled manner could cause potential environmental degradation.

Appendix C is a listing of Non-mapped sites. We recommend reviewing this section since some address information is insufficient to allow plotting within our mapping system.

**Agency File Date 1/09/96 **EDM Database updated 12/07/95



** ENVIRONMENTAL DATA MANAGEMENT **

FDEP
HAZARDOUS WASTE QUICK LOOK REPORT
(HWQL)

RAPID#	FACILITY ID NUMBER, NAME AND LOCATION	HAZARD TYPE CLASS
4	FLD984195438 EXXON CO USA #49131 HWY 54 & I-75 LAND O LAKES PERMIT NO:	SMALL QUANTITY GENERATOR FL PERMIT ISSUED: PERMIT EXPIRED:
9	FLD984254748 CIRCLE K #7475 HWY 54/I-75 ZEPHYRHILLS PERMIT NO:	SMALL QUANTITY GENERATOR FL PERMIT ISSUED: PERMIT EXPIRED:
12	FLD051565117 R N ROBERTS & ASSOC INC HWY 52 & I-75 DADE CITY PERMIT NO:	NON-HANDLER FL PERMIT ISSUED: PERMIT EXPIRED:

APPENDIX A

PROXIMAL SITES

The Proximal Sites Appendix includes mapped facilities that appear outside of the study area, but in the proximity of the research boundary. They are provided in a summary fashion to allow one to determine potential interest.

Generally, these sites may be of potential interest for three reasons:

- 1.) The location occurs so close to the research boundary that it merits inclusion in the evaluation.
- 2.) The site may be expansive with regard to the property boundary. The physical address of a landfill, for example may occur outside of the research boundary, but the landfill boundary may extend into the research area. Large industrial complexes may also fall into this category.
- 3.) The U.S. Census Bureau data, from which our maps are created, is not always precise with regard to address information. A facility may therefore appear on the map outside of the research area, but actually fall within the research area. These inaccuracies are typically less than 500 feet. If you observe any such inaccuracies, we ask that you please notify us of the more precise location and we will use this information to improve our product.

If more specific information relative to one or more locations included in the Proximal Sites Appendix is desired, please feel free to contact us and we will send you this information as an addendum to this report, at no additional cost.

APPENDIX B
2 MILE SUMMARY SITES

The 2 Mile Summary Appendix includes mapped facilities appearing on the NPL, CERCLIS, ERNS, STATE HAZARDOUS WASTE SITES LISTS (if applicable), and STATE SOLID WASTE FACILITIES lists within an approximate two mile radius of your subject location. These facilities are provided in a summarized fashion, in that the facilities listed on these databases are typically associated with the highest level of concern. Additionally, large facilities (such as landfills) may have a street address that maps outside of both your research boundary as well as the proximal research we provide in Appendix A, but with facility boundaries existing well inside of your research area. You therefore may wish additional information regarding these locations.

If more specific information relative to one or more locations included in the 2 Mile Summary Appendix is desired, please feel free to contact us and we will send you this information as an addendum to this report, at no additional cost.

** ENVIRONMENTAL DATA MANAGEMENT **

APPENDIX B

6/25/96

TWO MILE SUMMARY SITES LIST

Page 1

REGULATORY LISTS

=====

FEDERAL / STATE

=====

C
 N E E / S S S
 P R R / F I L
 L C N / A T D
 L I S / S E W
 S / S T
 S / T

APID# FACILITY ID NUMBER
NAME AND LOCATION

B). NONE 519
TAMPA DOWNS DUMP
HWY 54, 1MI W TAMPA DOWNS N 15-
LAND O LAKES FL X

B). 93-1600
D & D SHEET METAL
HWY 54 & 75 X
LUTZ FL

APPENDIX C

NON-MAPPED SITES

The Non-mapped Sites Appendix is a listing of facilities which lack sufficient address information to be placed within our mapping system.

These sites fall within three categories:

- 1.) Non-mapped records that contain a zipcode equal to the subject property (or any additional zipcode data you provide on the order form). Additionally, all records identified within your research boundary will be queried for alternate zipcodes, which will be added to this category.
- 2.) Non-mapped records that contain no zipcode information, but are listed within the same city as the subject property (or any additional cities you provide on the order form).
- 3.) Non-mapped records that contain no zipcode or city information, but are listed within the same county as the subject property. Adjacent county data will also be provided if the subject property is located near a county boundary.

** ENVIRONMENTAL DATA MANAGEMENT **

APPENDIX C
STANDARD RADIUS REPORT
NON-MAPPED SITES LISTED BY CITY
(BLANK OR UNIDENTIFIED ZIPCODES)

6/25/96

Page 2

REGULATORY LISTS

=====
FEDERAL / STATE
=====

FACILITY ID NUMBER,
NAME AND LOCATION

C	N	E	R	R	H	F	T	/	S	S	S	P	T	H	
	P	R	R	A	C	W	I	R	/	F	I	L	C	A	W
	L	C	N	A	R	D	N	I	/	A	T	D	T	N	Q
			L	S	T	I	M	D	/	S	E	W	S	K	L
			I	S	S	S	S	S	/		S	S			
			S						/		T				

---> FOR THE CITY OF WESLEY CHAPEL

***518944253 FL LEISURE BUILDERS
100 PASCO RD WESLEY CHAPEL FL

>>>>>>>>

X

STATE OF FLORIDA DEPARTMENT OF ENVIRONMENTAL PROTECTION

PETROLEUM CONTAMINATION TRACKING SYSTEM REPORT

(PCTS)

The PETROLEUM CONTAMINATION TRACKING SYSTEM EPORT identifies facilities and/or locations that have notified the FDEP of a possible release of contaminants from petroleum storage systems. The appearance of a site on this list is an indication that a release has occurred on the site and may pose a potential for environmental degradation of the site and surrounding properties. The PCTS list includes those sites that have been accepted into the State of Florida Early Detection Incentive (EDI) Program, the Petroleum Liability Insurance Restoration Program (PLIRP) and the Abandoned Tank Restoration Program (ATRP), which provide for State clean-up or reimbursement for the clean-up of sites that have been contaminated as a result of leaking fuel storage tanks. The PCTS lists also identifies sites that have notified the FDEP of a release but have not been accepted into either of these programs. These sites are identified by the word "OTHER" entered under the Program Field.

Sites that have been accepted into the EDI, PLIRP or ATRP Programs are typically issued a Rank and Score relative to the severity of the release that occurred. The Score that a site receives is compiled by assigning numerical values relative to the circumstances of the release. The Rank is determined by the value of the score issued to the site and represents the priority that the State has placed on initiating cleanup activities at the site.

In general, a site that is issued a high Score is assigned a relatively low numerical Rank. A low Rank value indicates a higher priority for response from the State.

The EDM PCTS report identifies those sites which presently appear, or have in the past appeared, on the PETROLEUM CONTAMINATION TRACKING SYSTEM REPORT.

Appendix C is a listing of Non-mapped sites. We recommend reviewed this section since some address information is insufficient to allow plotting within our mapping system.

** Agency File Date 2/28/96 ** EDM Database Updated 3/15/96



****ENVIRONMENTAL DATA MANGAGEMENT****

**FDEP
PETROLEUM CONTAMINATION TRACKING SYSTEM REPORT
(PCTS)**

6/25/96 *****GENERAL FACILITY INFORMATION*****

MAPID#

FACILITY ID#, NAME AND LOCATION

OWNERSHIP INFORMATION

2

518515016 OAKLEY GROVES INC
OAKLEY GROVES INC PO BOX 4170
SR 54 & I-75 LAKE WALES FL 338594170
ZEPHYRHILLS FL 33599 CONTACT: RONALD E OAKLEY
FACILITY TEL NO: 8139731087 CONTACT TEL NO: 8136381435

ALIAS NAME(S):

FACILITY TYPE: AGRIBUSINESS FACILITY TRACKING NO:
FAC SCORE: 000 FAC RANK: 00000 TOTAL FAC'S RANKED: 0000010680

*******INCIDENT INFORMATION*******

DISCOVERY DATE 07/19/1990

FAC ID# 518515016

INCIDENT PROGRAM: OTHER PROGRAM TYPE:

LEAD AGENCY: DISTRICT

INFO SOURCE: DISCHARGE NOTIFICATION

FDER COMMENT: NEW C/U REQUIRED

CONTAMINATED MEDIA: SOIL(Y/N): N SURFACE WATER(Y/N): N GROUND WATER(Y/N): Y MONITOR WELL(Y/N): N
POLLUTANT TYPE-EST GALS: 1) UNLEADED GAS -UNKNOWN 2) 3)
4) - 5) - 6) -

ELLEGIBILITY STATUS: DATE:

INITIAL REMEDIAL ACTION INFORMATION

ASSESSMENT INFORMATION

SITE REHABILITATION INFORMATION

RESP PARTY: OT FREE PRODUCT(Y/N):
SOIL REMOVAL(Y/N): Y SOIL TREATMENT(Y/N):
OTHER TREATMENT:

CAR RESP: OT LAST RCVD: 12/03/1991 ACTION:
RAP RESP: OT LAST RCVD: 08/18/1994 SUBMITTAL:
RAR RESP: OT LAST RCVD: 07/18/1995 STATUS:

ENVIRONMENTAL DATA MANGAGEMENT

FDEP
PETROLEUM CONTAMINATION TRACKING SYSTEM REPORT
(PCTS)

6/25/96

*****GENERAL FACILITY INFORMATION*****

MAPID#

FACILITY ID#, NAME AND LOCATION

OWNERSHIP INFORMATION

--HISTORICAL ENTRY--

6

518515078.
CHEVRON #47128-TILLACK'S
I-75 & SR 54
WESLEY CHAPEL FL
FACILITY TEL NO: 8139730133

CHEVRON USA PRODUCTS CO
PO BOX 1706
ATLANTA GA 303011706
CONTACT: CHERYL TENEYCK
CONTACT TEL NO: 4049843000

ALIAS NAME(S):

FACILITY TYPE: RETAIL STATION FACILITY TRACKING NO: 515821
FAC SCORE: 030 FAC RANK: 04403 TOTAL FAC'S RANKED: 0000010721

*****INCIDENT INFORMATION*****

DISCOVERY DATE 11/21/1988

FAC ID# 518515078.

INCIDENT PROGRAM: EDI PROGRAM TYPE: REIMBURS. CLEANUP LEAD AGENCY: BUR WASTE CLEANUP
INFO SOURCE: EDI FDER COMMENT: NEW C/U REQUIRED

CONTAMINATED MEDIA: SOIL(Y/N): N SURFACE WATER(Y/N): N GROUND WATER(Y/N): N MONITOR WELL(Y/N): Y
POLLUTANT TYPE-EST GALS: 1) UNKNOWN/NOT REPOR-UNKNOWN 2) - 3)
4) - 5) - 6) -

ELLIGIBILITY STATUS: PARTIAL DATE: 11/09/1994

INITIAL REMEDIAL ACTION INFORMATION

ASSESSMENT INFORMATION

SITE REHABILITATION INFORMATION

RESP PARTY: RP FREE PRODUCT(Y/N): CAR RESP: RP LAST RCVD: 12/08/1994 ACTION:
SOIL REMOVAL(Y/N): Y SOIL TREATMENT(Y/N): RAP RESP: LAST RCVD: SUBMITTAL:
OTHER TREATMENT: RAR RESP: LAST RCVD: STATUS:

*****INCIDENT INFORMATION*****

DISCOVERY DATE 09/09/1994

FAC ID# 518515078.

INCIDENT PROGRAM: OTHER PROGRAM TYPE: LEAD AGENCY: DISTRICT
INFO SOURCE: DISCHARGE NOTIFICATION FDER COMMENT: NEW C/U REQUIRED

CONTAMINATED MEDIA: SOIL(Y/N): N SURFACE WATER(Y/N): N GROUND WATER(Y/N): N MONITOR WELL(Y/N): Y
POLLUTANT TYPE-EST GALS: 1) UNLEADED GAS -UNKNOWN 2) - 3)
4) - 5) - 6) -

ELLIGIBILITY STATUS: DATE:

INITIAL REMEDIAL ACTION INFORMATION

ASSESSMENT INFORMATION

SITE REHABILITATION INFORMATION

RESP PARTY: FREE PRODUCT(Y/N): CAR RESP: LAST RCVD: ACTION:
SOIL REMOVAL(Y/N): SOIL TREATMENT(Y/N): RAP RESP: LAST RCVD: SUBMITTAL:
OTHER TREATMENT: RAR RESP: LAST RCVD: STATUS:

ENVIRONMENTAL DATA MANGAGEMENT

FDEP
PETROLEUM CONTAMINATION TRACKING SYSTEM REPORT
(PCTS)

6/25/96 *****GENERAL FACILITY INFORMATION*****

=====

MAPID#	FACILITY ID#, NAME AND LOCATION	OWNERSHIP INFORMATION
--------	---------------------------------	-----------------------

=====

8	518520035	AMOCO PETROLEUM PRODUCTS
	AMOCO #10710	600 CORPORATE DR #500
	15016 W HWY 54	FORT LAUDERDALE FL 333343607
	WESLEY CHAPEL FL 34249	CONTACT: RICARDO ALVEAR
	FACILITY TEL NO: 8136542880	CONTACT TEL NO: 3052742521

ALIAS NAME(S):

FACILITY TYPE: RETAIL STATION FACILITY TRACKING NO: 516773
FAC SCORE: 066 FAC RANK: 00919 TOTAL FAC'S RANKED: 0000010680

*****INCIDENT INFORMATION*****

DISCOVERY DATE 06/21/1988
FAC ID# 518520035

INCIDENT PROGRAM: EDI PROGRAM TYPE: REIMBURS. CLEANUP LEAD AGENCY: BUR WASTE CLEANUP
INFO SOURCE: CAR FDER COMMENT: NEW C/U REQUIRED

CONTAMINATED MEDIA: SOIL(Y/N): N SURFACE WATER(Y/N): N GROUND WATER(Y/N): N MONITOR WELL(Y/N): Y
POLLUTANT TYPE-EST GALS: 1) LEADED GAS -UNKNOWN 2) UNLEADED GAS -UNKNOWN 3) -
4) - 5) - 6) -

ELIGIBILITY STATUS: ELIGIBLE DATE: 06/07/1990

INITIAL REMEDIAL ACTION INFORMATION	ASSESSMENT INFORMATION	SITE REHABILITATION INFORMATION
=====	=====	=====
RESP PARTY: RP FREE PRODUCT(Y/N):	CAR RESP: RP LAST RCVD: 09/07/1993	ACTION:
SOIL REMOVAL(Y/N): SOIL TREATMENT(Y/N):	RAP RESP: LAST RCVD:	SUBMITTAL:
OTHER TREATMENT:	RAR RESP: LAST RCVD:	STATUS:

ENVIRONMENTAL DATA MANGAGEMENT

FDEP
PETROLEUM CONTAMINATION TRACKING SYSTEM REPORT
(PCTS)

6/25/96 *****GENERAL FACILITY INFORMATION*****

MAPID# FACILITY ID#, NAME AND LOCATION OWNERSHIP INFORMATION

12 518519953 MOBIL OIL CORP.
MOBIL #02-DHQ 3225 GALLOWS RD
I-75 & SR 52 W FAIRFAX VA 22037
DADE CITY FL 33576 CONTACT: CINDY BENZ
FACILITY TEL NO: CONTACT TEL NO: 7038495033

ALIAS NAME(S): MOBIL #02-DHQ

FACILITY TYPE: RETAIL STATION FACILITY TRACKING NO:
FAC SCORE: 010 FAC RANK: 07135 TOTAL FAC'S RANKED: 0000010680

*****INCIDENT INFORMATION*****

DISCOVERY DATE 02/08/1991

FAC ID# 518519953

INCIDENT PROGRAM: PLIRP PROGRAM TYPE: REIMBURS. CLEANUP LEAD AGENCY: BUR WASTE CLEANUP

INFO SOURCE: PLIRP (INSURANCE) FDER COMMENT: NEW C/U REQUIRED

CONTAMINATED MEDIA: SOIL(Y/N): Y SURFACE WATER(Y/N): N GROUND WATER(Y/N): Y MONITOR WELL(Y/N): Y
POLLUTANT TYPE-EST GALS: 1) LEADED GAS -UNKNOWN 2) UNLEADED GAS -UNKNOWN 3) UNKNOWN -UNKNOWN
4) - 5) - 6) -

ELIGIBILITY STATUS: ELIGIBLE DATE: 05/01/1991

INITIAL REMEDIAL ACTION INFORMATION

ASSESSMENT INFORMATION

SITE REHABILITATION INFORMATION

RESP PARTY: FREE PRODUCT(Y/N): CAR RESP: RP LAST RCVD: 02/03/1992 ACTION:
SOIL REMOVAL(Y/N): SOIL TREATMENT(Y/N): RAP RESP: LAST RCVD: 06/02/1992 SUBMITTAL:
OTHER TREATMENT: RAR RESP: LAST RCVD: STATUS:

****ENVIRONMENTAL DATA MANGAGEMENT****

**FDEP
PETROLEUM CONTAMINATION TRACKING SYSTEM REPORT
(PCTS)**

6/25/96 *****GENERAL FACILITY INFORMATION*****

MAPID#

=====

FACILITY ID#, NAME AND LOCATION	OWNERSHIP INFORMATION
---------------------------------	-----------------------

=====

13

518520041	R N ROBERTS & ASSOCIATES INC
ROBERTS & ASSOCIATES INC	33233 ST JOE RD
8611 SR 52	DADE CITY FL 33525
DADE CITY FL 33525	CONTACT: DAVID D ROBERTS
FACILITY TEL NO: 9043573339	CONTACT TEL NO: 9045675873

ALIAS NAME(S):

FACILITY TYPE: NON-RETAIL BUSINESS FACILITY TRACKING NO: 516530
FAC SCORE: 067 FAC RANK: 00903 TOTAL FAC'S RANKED: 0000010680

*****INCIDENT INFORMATION*****

DISCOVERY DATE 12/05/1988

FAC ID# 518520041

INCIDENT PROGRAM: EDI PROGRAM TYPE: STATE CLEANUP LEAD AGENCY: DISTRICT
INFO SOURCE: EDI FDER COMMENT: NEW C/U REQUIRED

CONTAMINATED MEDIA: SOIL(Y/N): Y SURFACE WATER(Y/N): N GROUND WATER(Y/N): Y MONITOR WELL(Y/N): Y
POLLUTANT TYPE-EST GALS: 1) KEROSENE -UNKNOWN 2) - 3) -
4) LEADED GAS -UNKNOWN 5) UNLEADED GAS -UNKNOWN 6) VEHIC DIESEL -UNKNOWN
ELIGIBILITY STATUS: INELIGIBLE DATE: 10/10/1990

INITIAL REMEDIAL ACTION INFORMATION	ASSESSMENT INFORMATION	SITE REHABILITATION INFORMATION
RESP PARTY: ST	FREE PRODUCT(Y/N):	CAR RESP: OT LAST RCVD: 10/10/1994 ACTION:
SOIL REMOVAL(Y/N):	SOIL TREATMENT(Y/N):	RAP RESP: ST LAST RCVD: 03/01/1995 SUBMITTAL:
OTHER TREATMENT:	RAR RESP:	LAST RCVD: STATUS:

*****INCIDENT INFORMATION*****

DISCOVERY DATE 08/26/1992

FAC ID# 518520041

INCIDENT PROGRAM: PLIRP PROGRAM TYPE: REIMBURS. CLEANUP LEAD AGENCY: BUR WASTE CLEANUP
INFO SOURCE: PLIRP (INSURANCE) FDER COMMENT: COMBINED C/U REQUIRED

CONTAMINATED MEDIA: SOIL(Y/N): Y SURFACE WATER(Y/N): N GROUND WATER(Y/N): Y MONITOR WELL(Y/N): Y
POLLUTANT TYPE-EST GALS: 1) UNKNOWN/NOT REPOR-UNKNOWN 2) - 3) -
4) - 5) - 6) -
ELIGIBILITY STATUS: ELIGIBLE DATE: 10/06/1992

INITIAL REMEDIAL ACTION INFORMATION	ASSESSMENT INFORMATION	SITE REHABILITATION INFORMATION
RESP PARTY:	FREE PRODUCT(Y/N):	CAR RESP: LAST RCVD: ACTION:
SOIL REMOVAL(Y/N):	SOIL TREATMENT(Y/N):	RAP RESP: LAST RCVD: SUBMITTAL:
OTHER TREATMENT:	RAR RESP:	LAST RCVD: STATUS:

ENVIRONMENTAL DATA MANGAGEMENT

FDEP
PETROLEUM CONTAMINATION TRACKING SYSTEM REPORT
(PCTS)

6/25/96 *****GENERAL FACILITY INFORMATION*****

MAPID# FACILITY ID#, NAME AND LOCATION OWNERSHIP INFORMATION

14 518630460 WARECO SYSTEM OF IOWA INC %WAREC
PASCO FUEL & FOOD SHOPPE PO BOX 1287
1-75 & SR 52 STUCKEY #279 JACKSONVILLE IL 626511287
SAN ANTONIO FL 33525 CONTACT: TODD R WARE
FACILITY TEL NO: 9047873315 CONTACT TEL NO: 2172459528

ALIAS NAME(S):

FACILITY TYPE: RETAIL STATION FACILITY TRACKING NO: 514632
FAC SCORE: 032 FAC RANK: 03819 TOTAL FAC'S RANKED: 0000010680

*****INCIDENT INFORMATION*****

DISCOVERY DATE 11/25/1988

FAC ID# 518630460

INCIDENT PROGRAM: EDI PROGRAM TYPE: STATE CLEANUP LEAD AGENCY: BUR WASTE CLEANUP
INFO SOURCE: EDI FDER COMMENT: NEW C/U REQUIRED

CONTAMINATED MEDIA: SOIL(Y/N): N SURFACE WATER(Y/N): N GROUND WATER(Y/N): Y MONITOR WELL(Y/N): Y
POLLUTANT TYPE-EST GALS: 1) UNKNOWN/NOT REPOR-UNKNOWN 2) - 3) -
4) - 5) - 6) -

ELIGIBILITY STATUS: ELIGIBLE DATE: 07/27/1989

INITIAL REMEDIAL ACTION INFORMATION ASSESSMENT INFORMATION SITE REHABILITATION INFORMATION
=====

RESP PARTY: ST	FREE PRODUCT (Y/N):	CAR RESP:	LAST RCVD:	ACTION:
SOIL REMOVAL (Y/N):	SOIL TREATMENT (Y/N):	RAP RESP:	LAST RCVD:	SUBMITTAL:
OTHER TREATMENT:		RAR RESP:	LAST RCVD:	STATUS:

=====

ENVIRONMENTAL DATA MANGAGEMENT

FDEP
PETROLEUM CONTAMINATION TRACKING SYSTEM REPORT
(PCTS)

6/25/96 *****GENERAL FACILITY INFORMATION*****

MAPID#

=====

FACILITY ID#, NAME AND LOCATION	OWNERSHIP INFORMATION
---------------------------------	-----------------------

=====

3

519046575	RADIANT OIL CO OF TAMPA INC
GAS KWICK #49	PO BOX 5238
28014 CR 54	TAMPA FL 336755238
WESLEY CHAPEL FL 34249	CONTACT: JOHN P MYERS JR
FACILITY TEL NO: 8132474731	CONTACT TEL NO: 8132474731

ALIAS NAME(S):

FACILITY TYPE: RETAIL STATION FACILITY TRACKING NO:
FAC SCORE: 030 FAC RANK: 04379 TOTAL FAC'S RANKED: 0000010680

*****INCIDENT INFORMATION*****

DISCOVERY DATE 06/13/1991

FAC ID# 519046575

INCIDENT PROGRAM: PLIRP PROGRAM TYPE: REIMBURS. CLEANUP LEAD AGENCY: BUR WASTE CLEANUP
INFO SOURCE: PLIRP (INSURANCE) FDER COMMENT: NEW C/U REQUIRED

CONTAMINATED MEDIA: SOIL(Y/N): N SURFACE WATER(Y/N): N GROUND WATER(Y/N): N MONITOR WELL(Y/N): Y
POLLUTANT TYPE-EST GALS: 1) UNLEADED GAS -UNKNOWN 2) - 3)
4) - 5) - 6) -

ELIGIBILITY STATUS: ELIGIBLE DATE: 02/26/1992

INITIAL REMEDIAL ACTION INFORMATION	ASSESSMENT INFORMATION	SITE REHABILITATION INFORMATION
RESP PARTY: FREE PRODUCT(Y/N):	CAR RESP: RP LAST RCVD: 07/25/1994	ACTION:
SOIL REMOVAL(Y/N): SOIL TREATMENT(Y/N):	RAP RESP: LAST RCVD:	SUBMITTAL:
OTHER TREATMENT:	RAR RESP: LAST RCVD:	STATUS:

ENVIRONMENTAL DATA MANGAGEMENT

FDEP
PETROLEUM CONTAMINATION TRACKING SYSTEM REPORT
(PCTS)

6/25/96 *****GENERAL FACILITY INFORMATION*****

MAPID# FACILITY ID#, NAME AND LOCATION OWNERSHIP INFORMATION

6

518515078 TILLACK & SONS INC
TILLACK & SONS INC 27829 W SR 54
27829 W SR 54 WESLEY CHAPEL FL 33543
WESLEY CHAPEL FL 33543
FACILITY TEL NO: 8139730133 CONTACT: JACK A TILLACK
CONTACT TEL NO: 8139730133

ALIAS NAME(S): CHEVRON #47128-TILLACK'S

FACILITY TYPE: RETAIL STATION FACILITY TRACKING NO: 515821
FAC SCORE: 030 FAC RANK: 04379 TOTAL FAC'S RANKED: 0000010680

*****INCIDENT INFORMATION*****

DISCOVERY DATE 11/21/1988

FAC ID# 518515078

INCIDENT PROGRAM: EDI PROGRAM TYPE: REIMBURS. CLEANUP LEAD AGENCY: BUR WASTE CLEANUP
INFO SOURCE: EDI FDER COMMENT: NEW C/U REQUIRED

CONTAMINATED MEDIA: SOIL(Y/N): N SURFACE WATER(Y/N): N GROUND WATER(Y/N): N MONITOR WELL(Y/N): Y
POLLUTANT TYPE-EST GALS: 1) UNKNOWN/NOT REPOR-UNKNOWN 2) - 3)
4) - 5) - 6) -

ELLEGIBILITY STATUS: PARTIAL DATE: 11/09/1994

INITIAL REMEDIAL ACTION INFORMATION ASSESSMENT INFORMATION SITE REHABILITATION INFORMATION
=====
RESP PARTY: RP FREE PRODUCT(Y/N): CAR RESP: RP LAST RCVD: 12/08/1994 ACTION:
SOIL REMOVAL(Y/N): Y SOIL TREATMENT(Y/N): RAP RESP: LAST RCVD: SUBMITTAL:
OTHER TREATMENT: RAR RESP: LAST RCVD: STATUS:

*****INCIDENT INFORMATION*****

DISCOVERY DATE 09/09/1994

FAC ID# 518515078

INCIDENT PROGRAM: OTHER PROGRAM TYPE: LEAD AGENCY: DISTRICT
INFO SOURCE: DISCHARGE NOTIFICATION FDER COMMENT: NEW C/U REQUIRED

CONTAMINATED MEDIA: SOIL(Y/N): N SURFACE WATER(Y/N): N GROUND WATER(Y/N): N MONITOR WELL(Y/N): Y
POLLUTANT TYPE-EST GALS: 1) UNLEADED GAS -UNKNOWN 2) - 3)
4) - 5) - 6) -

ELLEGIBILITY STATUS: DATE:

INITIAL REMEDIAL ACTION INFORMATION ASSESSMENT INFORMATION SITE REHABILITATION INFORMATION
=====
RESP PARTY: FREE PRODUCT(Y/N): CAR RESP: LAST RCVD: ACTION:
SOIL REMOVAL(Y/N): SOIL TREATMENT(Y/N): RAP RESP: LAST RCVD: SUBMITTAL:
OTHER TREATMENT: RAR RESP: LAST RCVD: STATUS:

ENVIRONMENTAL DATA MANGAGEMENT

FDEP
PETROLEUM CONTAMINATION TRACKING SYSTEM REPORT
(PCTS)

6/25/96 *****GENERAL FACILITY INFORMATION*****

MAPID# FACILITY ID#, NAME AND LOCATION OWNERSHIP INFORMATION

10 518520488 CIRCLE K STORES INC
CIRCLE K #7475 5650 BRECKENRIDGE PARK DR #300
HWY 54 & I-75 TAMPA FL 33610
ZEPHYRHILLS FL 33599 CONTACT: STEVE BELIN
FACILITY TEL NO: 8136898161 CONTACT TEL NO: 8136215528

ALIAS NAME(S):

FACILITY TYPE: RETAIL STATION FACILITY TRACKING NO: 513358
FAC SCORE: 041 FAC RANK: 02362 TOTAL FAC'S RANKED: 0000010680

*****INCIDENT INFORMATION*****

DISCOVERY DATE 12/09/1987

FAC ID# 518520488

INCIDENT PROGRAM: EDI PROGRAM TYPE: REIMBURS. CLEANUP LEAD AGENCY: BUR WASTE CLEANUP
INFO SOURCE: EDI FDER COMMENT: NEW C/U REQUIRED

CONTAMINATED MEDIA: SOIL(Y/N): N SURFACE WATER(Y/N): N GROUND WATER(Y/N): N MONITOR WELL(Y/N): Y
POLLUTANT TYPE-EST GALS: 1) LEADED GAS -UNKNOWN 2) - 3)
4) - 5) - 6) -

ELIGIBILITY STATUS: ELIGIBLE DATE: 09/06/1991

INITIAL REMEDIAL ACTION INFORMATION ASSESSMENT INFORMATION SITE REHABILITATION INFORMATION
=====

RESP PARTY: RP	FREE PRODUCT(Y/N): Y	CAR RESP: RP	LAST RCVD: 04/13/1995	ACTION:
SOIL REMOVAL(Y/N):	SOIL TREATMENT(Y/N):	RAP RESP:	LAST RCVD:	SUBMITTAL:
OTHER TREATMENT:		RAR RESP:	LAST RCVD:	STATUS:

